

MOUNTING SYSTEMS



MOUNTING SYSTEMS

THREADED ROD FIXING		
FL	Fixing clamp for threaded rod	5-221
PBR	Adjustable ceiling bracket	5-221
SDBG	Steeldeck bracket	5-221
VFCB	Central suspension bracket	5-222
OBG	Upper bracket	5-222
BG	Inside bracket	5-223
DR15.30	Supporting profile	5-224
DR21.41	Supporting profile	5-225
WIRE SUSPENSION		
CSL	Wire suspension lock	5-225
CS45LP	Wire suspension with loop	5-226
CS90LP	Wire suspension with loop	5-226
CS45SH	Wire suspension with snap hook	5-227
CS90SH	Wire suspension with snap hook	5-227
CS45M6	Wire suspension with stud bolt M6	5-228
CS90M8	Wire suspension with stud bolt M8	5-228
CS90EY	Wire suspension with eyelet	5-228
CS45TG	Wire suspension with toggle	5-229
CS90TG	Wire suspension with toggle	5-229
CS45SHYA	Wire suspension Y-split acc. with hooks	5-230
CS90SHYA	Wire suspension Y-split acc. with hooks	5-230
CS45SHY	Wire suspension Y-split with hooks	5-231
CS90SHY	Wire suspension Y-split with hooks	5-231
BRACKETS		
VMB	Floor and wall bracket	5-232
OBZ130	Open suspension bracket	5-232
OBZ180	Open suspension bracket	5-233
COMEGACLU170	Open suspension bracket universal	5-234
COMEGACLU290	Open suspension bracket universal	5-235
CANTILEVER		
CCLI	Bracket for wall, ceiling and cable	5-235
LOMEGACLU150	Wall bracket universal	5-236
VOMEGA	Joining piece	5-236
HDMBZ	Wall support	5-237
WSUN	Universal support bracket	5-237
KCL	Snap-in bracket	5-238
WKS	Bolted bracket	5-239
WKSS	Adjustable bracket	5-240
HDWK	Welded bracket	5-241
WKCL	Snap-in bracket for MP-profile or MBWK	5-242
WKMP41.21	Bolt-on wall bracket MP41.21	5-242
WKMPCL41.21	Bolt-on wall bracket MP41.21	5-243
WKMP41.41	Bolt-on wall bracket MP41.41	5-243
WKMPCL41.41	Universal wall bracket MP41.41	5-244
WKUMP41.41	Bolt-on bracket MP41.41 for ceil. prof.	5-244
WKUMPCL41.41	Universal bracket MP41.41 for ceil. prof	5-245
HDWKM	Heavy welded bracket	5-246
HDWKMD	Heavy welded double bracket	5-246
HDHKI	Welded clamping bracket	5-247
HDUKPIZ	Universal adapter	5-247
HDHKIZ	Extra heavy duty welded clamping bracket	5-248
CEILING PROFILES		
KPCL	Clippable headplate	5-248
MPCL41.21	Clippable assembly profile	5-249
HDHSLECL	Single ceiling profile clippable	5-250
CLHS	Snap-in adapter for HDHSLECL	5-250
HDHSLDCL	Double ceiling profile	5-251
HSLE3	Single ceiling profile perfo 3 sides	5-251
HSMES	Single ceiling profile	5-252
HSMD	Double ceiling profile	5-253
HDHSMD	Double ceiling profile	5-253

HDHSMU50	Ceiling profile medium heavy	5-254
HDTSU	Spacer for HDHSMU50	5-254
HDHSIZ	Heavy ceiling profile	5-255
CEILING PROFILES ACCESSORIES		
DOP41.21	End cap for MP41.21	5-255
DOP41.41	End cap for MP41.41	5-256
DOP41.82	End cap for MP41.82	5-256
DOPHSMU	Protection cap for HSMU50	5-256
HDSKP	Adjustable head plate	5-257
HDPIPE ACCESSORIES		
HDPIPE80S	Perforated I-profile	5-257
DOPIPE80	End cap for HDPIPE80S	5-258
HDIPLO6	Headplate for HDPIPE80S	5-258
HDIPLO10	Headplate for HDPIPE80S	5-258
HDSKIPE	Hinged headplate for HDPIPE80S	5-259
HDKPIPE	Joining piece for HDPIPE80S	5-259
HDDKIPE	Cross joiner for HDPIPE80S	5-260
HDKIPE	Mounting piece HDPIPE80S	5-260
HDWVPIPE	Bolted bracket	5-260
PROFILES		
L25	L-profile	5-261
L25.50	L-profile	5-261
L50.50	L-profile	5-261
Z25	Z-profile	5-262
Z50	Z-profile	5-262
U24	U-profile 24	5-263
U48	U-profile 48	5-263
MP41.21	Assembly profile	5-264
HDMP41.21	Assembly profile	5-264
MP41.41	Assembly profile	5-265
HDMP41.41	Assembly profile	5-265
MP41.41DG	Double assembly profile	5-266
HDMP41.41DG	Double assembly profile	5-266
MP3.41.41	Assembly profile perforation on 3 sides	5-267
SKPE	Adjustable head plate single	5-267
SKPD	Adjustable head plate double	5-267
VS MOUNTING		
VS41	Assembly accessory	5-268
HDVS41 00-39	Assembly accessory	5-269
HDVS41 41-62	Assembly accessory	5-270
MOUNTING ACCESSORIES		
TIM	Threaded rod (DIN 975)	5-270
VM6334	Coupling nut (DIN 6334)	5-271
GM	Sliding nut for supporting profile	5-272
GM41	Sliding nut for supporting profile	5-272
GMV41	Sliding nut spring supporting profile	5-272
B	Bolt (DIN 933)	5-273
RBK	Round head square neck bolt (DIN 603)	5-273
M	Nut (DIN 934)	5-274
VM	Toothed round head bolt / flange nut	5-274
VMK	Round head square neck bolt / flange nut	5-274
RB	Toothed round head bolt	5-275
RM	Flange nut (DIN 6923)	5-275
CRO	Flat giant washer (DIN 9021)	5-275
RO	Giant washer (DIN 125-1 A)	5-276
ROTD	Vibration damping washer	5-276
VSZ	Galvaspray 400 ml	5-276
RBS	Edge protection	5-277
	TECHNICAL INFORMATION	5-279

LOAD CAPACITY OF CEILING PROFILES

Ceiling Profiles	Moment M (Nm)	Maximum Load S (daN)
VSCL41.37 + MP3.41.41	85	700
MP + KPCL	90	300
HDHSLECL	130	1000
WKMP41.21	130	1500
HDHSLDCL	380	1800
VSCL41.60 + MP3.41.41	400	1300
HSLE3	400	1800
HDHSMU50	430	2100
WKMP41.41	475	2000
HSMES	480	1800
HSMD	1600	3500
HDHSIZ	2150	2940

Tested according IEC 61537

F = Load or force onto the bracket

a = Distance from the load to the centerline of the ceiling profile (m)

L = Length of the ceiling profile (m)

M = Moment (daNm) = F x a

f = Deflection of the ceiling profile (mm)

Maximum permissible deflection = L/20 or 5% of the length

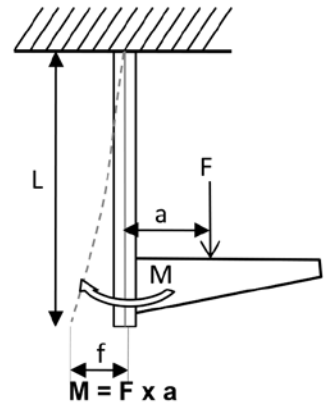

MULTIPLE LOADS

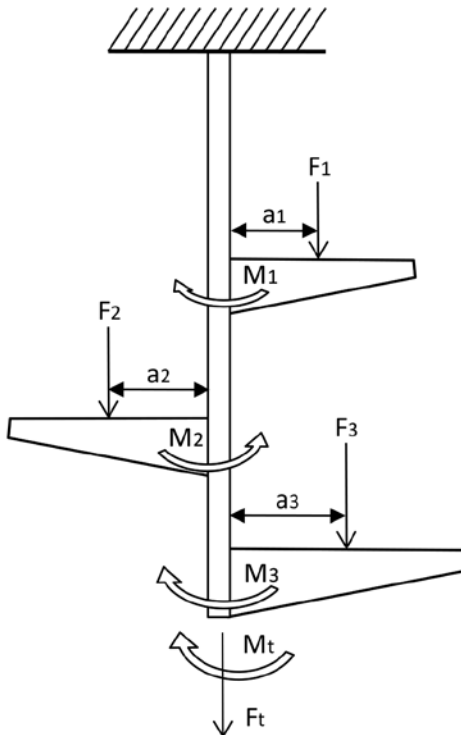

$$F_t = F_1 + F_2 + F_3$$

Total load = sum of all loads

$$M_t = (M_1 + M_3) - M_2 = (F_1 \times a_1 + F_3 \times a_3) - (F_2 \times a_2)$$

Total Moment = sum of all Moments to the left – sum of all Moments to the right

The following 2 conditions should always be met :

Condition 1 :

Total Moment (M_t) \leq Max. Moment of the ceiling profile (M- of Moment-values, see tabel)

and

Condition 2 :

Total Load or Force (F_t) \leq Max. Load of the ceiling profile (S-values, see tabel)

Remark:

When symmetrical load is perfect : $M_t = 0$

In that case, only the second condition is valid : Total Load (F_t) \leq Max. Load of the ceiling profile (S)

WEIGHT PER SUPPORT

The following formula is used:

$$\text{Weight per support (daN)} = (\text{cable load / meter} + \text{own weight of the cable support system / meter}) \times \text{support distance}$$

EXAMPLE 1 : Cable tray KBSI60.300.125 mounted on WKS300. What is the maximum support or span distance ?

Calculated maximum cable load = 45 daN/m (45 kg/m)

Own weight of the cable tray KBSI60.300.125 = 3,7 daN/m (3,70 kg/m)

Max. load support WKS300 = 130 daN

Weight per support (45 daN/m + 3,7 daN/m) x support distance = 130 daN

Max. support distance = 130 daN / (44 daN/m + 3,7 daN/m) = 2,7 m

Remark : The load diagram of the cable support system shows that a load of 44 daN/m of 44 kg/m is no problem on such a support distance.

EXAMPLE 2 : Cable ladder KLM400, support distance 4m. Which support will we chose ?

Calculated maximum cable load = 90,8 daN/m (90,8 kg/m)

Remark : The load diagram of the KLM shows that the load of 90,8 daN/m at the support distance of 4 m is no problem.

Own weight of cable ladder KLM400 = 6,64 daN/m (6,64 kg/m)

Weight per support : (90,8 daN/m + 6,64 daN/m) x 4 = 389,8 daN

Remark : The maximum load values for supports shows that a HDWK400 is a good choice, as this support can carry a maximum of 430 kg/m.

CABLE LOAD

The weight the cable tray or cable ladder can bear, can be calculated on the basis of the weight of the desired cables, specified by the cable manufacturer.

The maximum number of cables is limited by the cross-section (fill area) of the cable tray / ladder.

In no case should the load be higher than indicated in the load diagram of the desired cable support system.

On the basis of the following formula, the approximate cable weight can be calculated :

$$\text{Cable weight per meter (daN/m)} = \text{useful cross-section of the cable support system (mm}^2\text{)} \times \frac{0,0025 \text{ daN}}{\text{m} \times \text{mm}^2}$$

$\frac{0,0025 \text{ daN}}{\text{m} \times \text{mm}^2}$ is based on the specific gravity of copper and the average amount of insulator and air per intersection.

EXAMPLE 1 : Cable tray KBSI60.300.125

Useful width = 300 mm

Useful height = 60 mm

Useful fill area : 300 mm x 60 mm = 18000 mm²

Cable weight per meter (daN/m) : 18000 mm² x $\frac{0,0025 \text{ daN}}{\text{m} \times \text{mm}^2}$ = 45 daN/m (45 kg/m)

Rule of thumb :

A cable tray of 60 mm height can carry 15 kg cable per running meter per 100 mm width.

KBSI60.300 is designed to carry 15x3 = 45 kg/m.

EXAMPLE 2 : Cable ladder KLM400

Useful inner width = 356 mm

Useful inner height = 102 mm

Useful fill area : 356 mm x 102 mm = 36312 mm²

Cable weight per meter (daN/m) : 36312 mm² x $\frac{0,0025 \text{ daN}}{\text{m} \times \text{mm}^2}$ = 90,8 daN/m (90,8 kg/m)

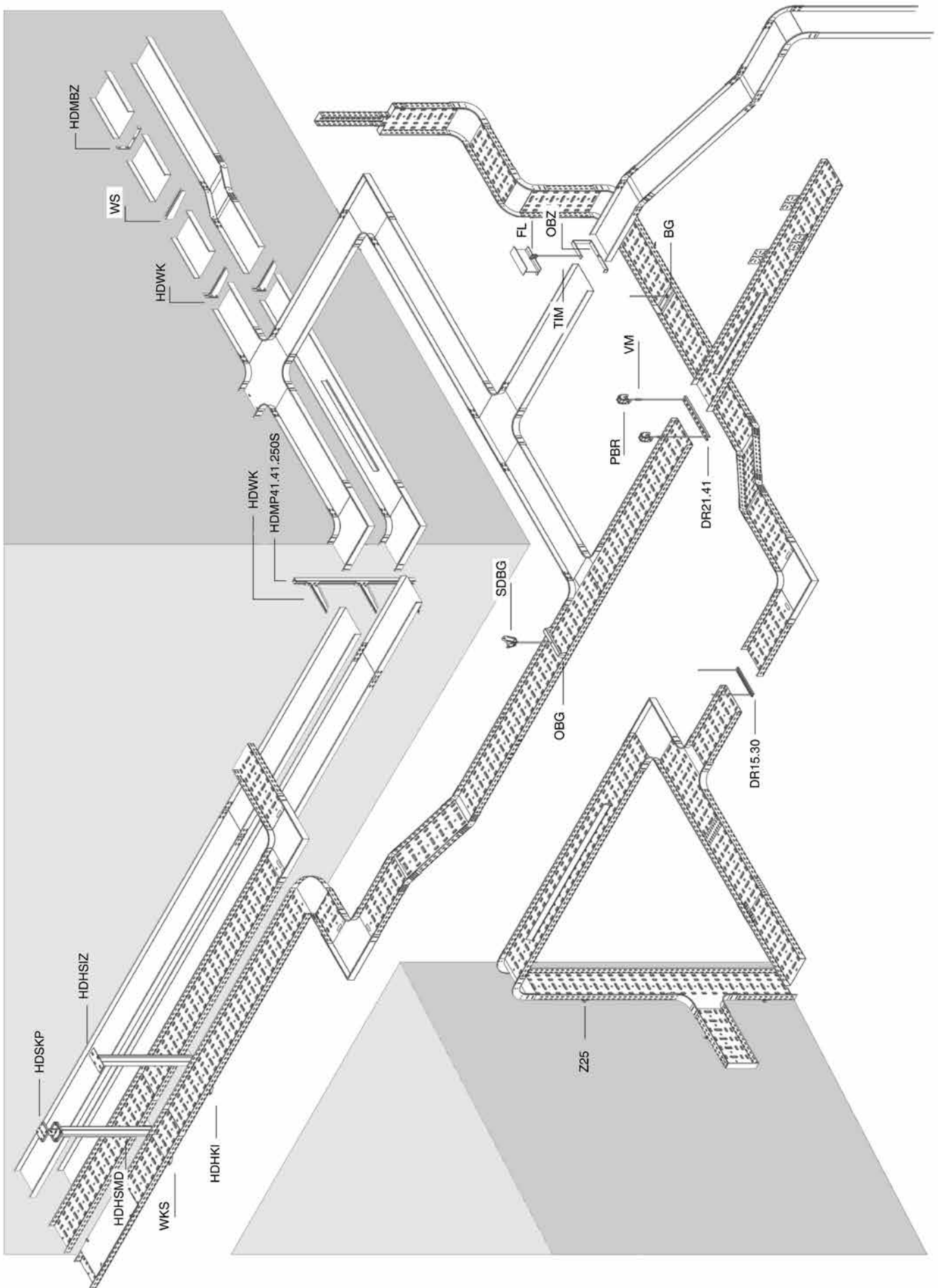

FL

Fixing clamp for threaded rod

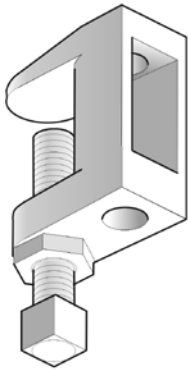

Standard finish

Electro zinc-plated

Reference	Max. load (in daN)	Clamp range
FL1	250	0-22 mm
FL2	250	0-19 mm
FL3	350	5-25 mm

HD	Reference	↑ mm	↔ mm	↔ mm	↔ mm	kg/piece	⊞	Stock	Unit
-	FL1	-		M8	-	0.140	50	✓	piece
-	FL2	-		M10	-	0.150	50	✓	piece
-	FL3	-		M12	-	0.210	50	✓	piece

The fixing clamp is useful for I-profiles which are placed horizontally and for I-profiles with a certain angle of inclination. The fixing clamp is delivered with an adjustable screw and lock-nut. Threaded rod should be ordered separately.

PBR

Adjustable ceiling bracket

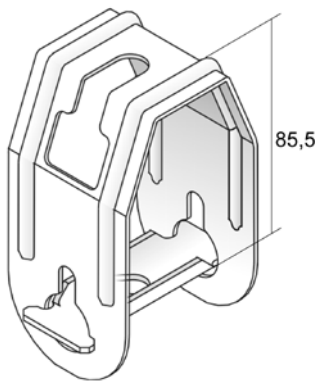

Perfect for a light inclining roof construction.

Max. load

170 daN

Standard finish

Pre-galvanised

HD	Reference	↑ mm	↔ mm	↔ mm	↔ mm	kg/piece	⊞	Stock	Unit
-	PBR	-			-	0.140	48	✓	piece

To order per full packaging.
Threaded rod TIM8 or TIM10 to be ordered separately.

SDBG

Steeldeck bracket

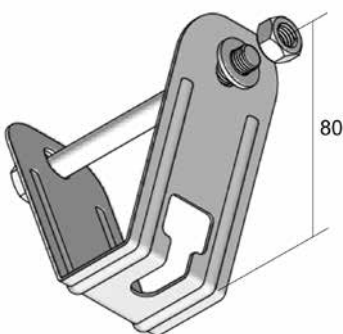

For fixing to steel roof constructions.

Max. load

300 daN

Standard finish

Pre-galvanised

HD	Reference	↑ mm	↔ mm	↔ mm	↔ mm	kg/piece	⊞	Stock	Unit
-	SDBG	-			-	0.200	48	✓	piece

To order per full packaging.
Included: Bolt B10.110, nut M10 and washer RO10.

VFCB

Central suspension bracket



Standard finish	Pre-galvanised
Optional finish HD	Hot-dip galvanised
Optional finish PE	Coating

HD	Reference	↑ mm	↔ mm	↔ mm	↔ mm	kg/piece	⊞	Stock	Unit
HD	VFCB	-				0.035	60	✓	piece

To order per full packaging.

2 pieces for threaded rod suspension M6/M8.

Can be used for wire cable trays: VFUL35.100, VFU(L)60.100, VFUL60.150

1 piece for direct mounting to the ceiling

Can be used for wire cable trays: GVFUL55.100, GVFUL60.150, GVFUL100.100 and GVFUL100.150.

OBG

Upper bracket

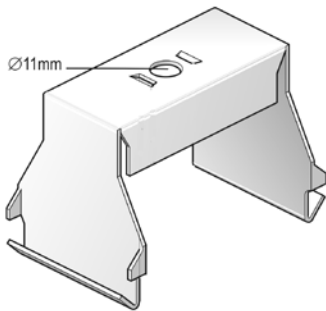

To mount cable trays with partition.

Standard finish	Pre-galvanised
Optional finish HD	Hot-dip galvanised
Optional finish PE	Coating

	Max. load (in daN)
OBG050	200
OBG075	200
OBG100	200
OBG150	200
OBG200	200
OBG250	150
OBG300	150
OBG400	90

HD	Reference	↑ mm	↔ mm	↔ mm	↔ mm	kg/piece	⊞	Stock	Unit
HD	OBG050	64	55		-	0.100	12	✓	piece
HD	OBG075	64	80		-	0.130	12	✓	piece
HD	OBG100	64	105		-	0.140	12	✓	piece
HD	OBG150	64	155		-	0.190	12	✓	piece
HD	OBG200	64	205		-	0.220	12	✓	piece
HD	OBG250	64	255		-	0.270	12	✓	piece
HD	OBG300	64	305		-	0.310	6	✓	piece
HD	OBG400	64	405		-	0.390	6	✓	piece

To order per full packaging.

To be mounted with threaded rod TIM8 or TIM10.

BG

Inside bracket

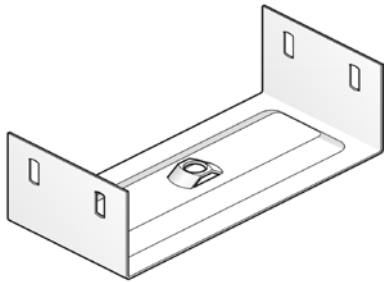

To order	Height 35 mm
Standard finish	Pre-galvanised
Optional finish HD	Hot-dip galvanised
Optional finish PE	Coating

Width	Max. load (in daN)
BG075	200
BG100	200
BG150	200
BG200	150
BG250	120
BG300	90
BG400	30

HD	Reference	↑ mm	↔ mm	↔ mm	↔ mm	kg/piece	📦	Stock	Unit
HD	BG60.075	54	70		-	0.200	12	✓	piece
HD	BG60.100	54	95		-	0.210	12	✓	piece
HD	BG60.150	54	145		-	0.270	12	✓	piece
HD	BG60.200	54	195		-	0.330	12	✓	piece
HD	BG60.250	54	245		-	0.380	12	✓	piece
HD	BG60.300	54	295		-	0.430	6	✓	piece
HD	BG60.400	54	395		-	0.530	6	✓	piece

To order per full packaging.
Delivered with nut M10.
To be fixed with threaded rod TIM10.

DR15.30

Supporting profile

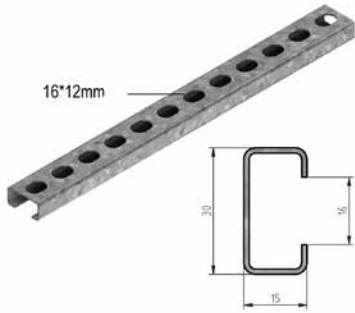

Max. load	100 daN
Standard finish	Pre-galvanised
Optional finish HD	Hot-dip galvanised
Optional finish PE	Coating

HD	Reference	↑ mm	↔ mm	↔ mm	↔ mm	kg/piece	📦	Stock	Unit
HD	DR100	15	30		100	0.060	50	✓	piece
HD	DR150	15	30		150	0.080	50	✓	piece
HD	DR200	15	30		200	0.110	50	✓	piece
HD	DR250	15	30		250	0.130	50	✓	piece
HD	DR300	15	30		300	0.160	50	✓	piece
HD	DR350	15	30		350	0.190	50	✓	piece
HD	DR15.30.2000	15	30		2000	0.600	2		m

To be fixed with two threaded rods TIM8 + nut M8 + CRO8.
Always order the width of the cable tray + 50 mm.

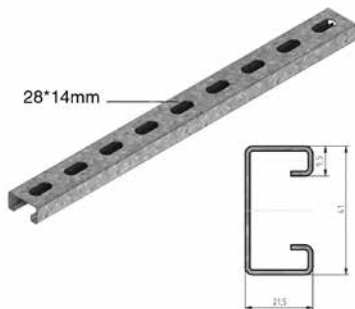
DR21.41**Supporting profile**

Max. load	150 daN
Standard finish	Pre-galvanised
Optional finish HD	Hot-dip galvanised
Optional finish PE	Coating

HD	Reference	↑ mm	↔ mm	↔ mm	↔ mm	kg/piece	📦	Stock	Unit
HD	DR450	21	41		450	0.500	6	✓	piece
HD	DR550	21	41		550	0.620	6	✓	piece
HD	DR650	21	41		650	0.700	6	✓	piece

To order per full packaging.
To be fixed with two threaded rods TIM10 + nut M10 + CRO10.
Always order the width of the cable tray + 50 mm.

CSL**Wire suspension lock**

Max. load	CSL45: 45 daN
Max. load	CSL90: 90 daN
Standard finish	Aluminium

HD	Reference	↑ mm	↔ mm	↔ mm	↔ mm	kg/piece	📦	Stock	Unit
-	CSL45	-			-	0.020	10		piece
-	CSL90	-			-	0.050	10		piece

The technical information for this product can be found at the end of this chapter.
To order per 10 pieces.

CS45LP

Wire suspension with loop



Max. load	45 daN
Standard finish	Pre-galvanised

HD	Reference	↑ mm	↔ mm	↔ mm	↔ mm	kg/piece	⊞	Stock	Unit
-	CS45LP1	-			1000	0.020	10		piece
-	CS45LP2	-			2000	0.040	10		piece
-	CS45LP3	-			3000	0.060	10		piece
-	CS45LP4	-			4000	0.080	10		piece
-	CS45LP5	-			5000	0.100	10		piece
-	CS45LP10	-			10000	0.200	10		piece

To order per 10 pieces.

CS90LP

Wire suspension with loop



Max. load	90 daN
Standard finish	Pre-galvanised

HD	Reference	↑ mm	↔ mm	↔ mm	↔ mm	kg/piece	⊞	Stock	Unit
-	CS90LP1	-			1000	0.060	10		piece
-	CS90LP2	-			2000	0.120	10		piece
-	CS90LP3	-			3000	0.180	10		piece
-	CS90LP4	-			4000	0.240	10		piece
-	CS90LP5	-			5000	0.300	10		piece
-	CS90LP10	-			10000	0.600	10		piece

To order per 10 pieces.

CS45SH**Wire suspension with snap hook**

Max. load 45 daN

Standard finish Pre-galvanised

HD	Reference	↑ mm	↔ mm	↔ mm	↔ mm	kg/piece	📦	Stock	Unit
-	CS45SH1	-			1000	0.020	10		piece
-	CS45SH2	-			2000	0.040	10		piece
-	CS45SH3	-			3000	0.060	10		piece
-	CS45SH4	-			4000	0.080	10		piece
-	CS45SH5	-			5000	0.100	10		piece
-	CS45SH10	-			10000	0.200	10		piece

To order per 10 pieces.

CS90SH**Wire suspension with snap hook**

Max. load 90 daN

Standard finish Pre-galvanised

HD	Reference	↑ mm	↔ mm	↔ mm	↔ mm	kg/piece	📦	Stock	Unit
-	CS90SH1	-			1000	0.060	10		piece
-	CS90SH2	-			2000	0.120	10		piece
-	CS90SH3	-			3000	0.180	10		piece
-	CS90SH4	-			4000	0.240	10		piece
-	CS90SH5	-			5000	0.300	10		piece
-	CS90SH10	-			10000	0.600	10		piece

To order per 10 pieces.

CS45M6

Wire suspension with stud bolt M6



Max. load	45 daN
Standard finish	Pre-galvanised

HD	Reference	↑ mm	↔ mm	↔ mm	↔ mm	kg/piece	⊞	Stock	Unit
-	CS45M61	-			1000	0.020	10		piece
-	CS45M62	-			2000	0.040	10		piece
-	CS45M63	-			3000	0.060	10		piece
-	CS45M64	-			4000	0.080	10		piece
-	CS45M65	-			5000	0.100	10		piece
-	CS45M610	-			10000	0.200	10		piece

To order per 10 pieces.

CS90M8

Wire suspension with stud bolt M8



Max. load	90 daN
Standard finish	Pre-galvanised

HD	Reference	↑ mm	↔ mm	↔ mm	↔ mm	kg/piece	⊞	Stock	Unit
-	CS90M81	-			1000	0.060	10		piece
-	CS90M82	-			2000	0.120	10		piece
-	CS90M83	-			3000	0.180	10		piece
-	CS90M84	-			4000	0.240	10		piece
-	CS90M85	-			5000	0.300	10		piece
-	CS90M810	-			10000	0.600	10		piece

To order per 10 pieces.

CS90EY

Wire suspension with eyelet



Max. load	90 daN
Standard finish	Pre-galvanised

HD	Reference	↑ mm	↔ mm	↔ mm	↔ mm	kg/piece	⊞	Stock	Unit
-	CS90EY1	-			1000	0.060	10		piece
-	CS90EY2	-			2000	0.120	10		piece
-	CS90EY3	-			3000	0.180	10		piece
-	CS90EY4	-			4000	0.240	10		piece
-	CS90EY5	-			5000	0.300	10		piece
-	CS90EY10	-			10000	0.600	10		piece

To order per 10 pieces.

CS45TG**Wire suspension with toggle**

Max. load 45 daN

Standard finish Pre-galvanised

HD	Reference	↑ mm	↔ mm	↔ mm	↔ mm	kg/piece	📦	Stock	Unit
-	CS45TG1	-			1000	0.020	10		piece
-	CS45TG2	-			2000	0.040	10		piece
-	CS45TG3	-			3000	0.060	10		piece
-	CS45TG4	-			4000	0.080	10		piece
-	CS45TG5	-			5000	0.100	10		piece
-	CS45TG10	-			10000	0.200	10		piece

To order per 10 pieces.

CS90TG**Wire suspension with toggle**

Max. load 90 daN

Standard finish Pre-galvanised

HD	Reference	↑ mm	↔ mm	↔ mm	↔ mm	kg/piece	📦	Stock	Unit
-	CS90TG1	-			1000	0.060	10		piece
-	CS90TG2	-			2000	0.120	10		piece
-	CS90TG3	-			3000	0.180	10		piece
-	CS90TG4	-			4000	0.240	10		piece
-	CS90TG5	-			5000	0.300	10		piece
-	CS90TG10	-			10000	0.600	10		piece

To order per 10 pieces.

CS45SHYA

Wire suspension Y-split acc. with hooks



Max. load	45 daN
Standard finish	Pre-galvanised

HD	Reference	↑ mm	↔ mm	↔ mm	↔ mm	kg/piece	⊞	Stock	Unit
-	CS45SH150YA	-	150		-	0.100	10		piece
-	CS45SH300YA	-	300		-	0.100	10		piece
-	CS45SH500YA	-	500		-	0.200	10		piece
-	CS45SH800YA	-	800		-	0.200	10		piece

To order per 10 pieces.

CS90SHYA

Wire suspension Y-split acc. with hooks



Max. load	90 daN
Standard finish	Pre-galvanised

HD	Reference	↑ mm	↔ mm	↔ mm	↔ mm	kg/piece	⊞	Stock	Unit
-	CS90SH150YA	-	150		-	0.150	10		piece
-	CS90SH300YA	-	300		-	0.150	10		piece
-	CS90SH500YA	-	500		-	0.300	10		piece
-	CS90SH800YA	-	800		-	0.300	10		piece

To order per 10 pieces.

CS45SHY

Wire suspension Y-split with hooks



Max. load 45 daN

Standard finish Pre-galvanised

HD	Reference	↑ mm	↔ mm	↔ mm	↔ mm	kg/piece	📦	Stock	Unit
-	CS45SH150Y1	-	150		1000	0.100	10		piece
-	CS45SH150Y2	-	150		2000	0.100	10		piece
-	CS45SH150Y3	-	150		3000	0.100	10		piece
-	CS45SH300Y1	-	300		1000	0.150	10		piece
-	CS45SH300Y2	-	300		2000	0.150	10		piece
-	CS45SH300Y3	-	300		3000	0.150	10		piece
-	CS45SH500Y1	-	500		1000	0.250	10		piece
-	CS45SH500Y2	-	500		2000	0.250	10		piece
-	CS45SH500Y3	-	500		3000	0.250	10		piece
-	CS45SH800Y1	-	800		1000	0.400	10		piece
-	CS45SH800Y2	-	800		2000	0.400	10		piece
-	CS45SH800Y3	-	800		3000	0.400	10		piece

To order per 10 pieces.

CS90SHY

Wire suspension Y-split with hooks



Max. load 90 daN

Standard finish Pre-galvanised

HD	Reference	↑ mm	↔ mm	↔ mm	↔ mm	kg/piece	📦	Stock	Unit
-	CS90SH150Y1	-	150		1000	0.200	10		piece
-	CS90SH150Y2	-	150		2000	0.200	10		piece
-	CS90SH150Y3	-	150		3000	0.200	10		piece
-	CS90SH300Y1	-	300		1000	0.250	10		piece
-	CS90SH300Y2	-	300		2000	0.250	10		piece
-	CS90SH300Y3	-	300		3000	0.250	10		piece
-	CS90SH500Y1	-	500		1000	0.400	10		piece
-	CS90SH500Y2	-	500		2000	0.400	10		piece
-	CS90SH500Y3	-	500		3000	0.400	10		piece
-	CS90SH800Y1	-	800		1000	0.600	10		piece
-	CS90SH800Y2	-	800		2000	0.600	10		piece
-	CS90SH800Y3	-	800		3000	0.600	10		piece

To order per 10 pieces.

VMB

Floor and wall bracket

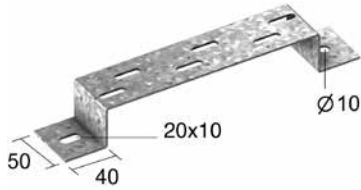

Suitable as floor-, wall-, and suspension bracket.

Max. load	200 daN
Standard finish	Pre-galvanised
Optional finish HD	Hot-dip galvanised
Optional finish PE	Coating

HD	Reference	↑ mm	↔ mm	↔ mm	↔ mm	kg/piece	📦	Stock	Unit
HD	VMB100	40	100		-	0.190	30	✓	piece
HD	VMB150	40	150		-	0.220	30	✓	piece
HD	VMB200	40	200		-	0.260	30	✓	piece
HD	VMB300	40	300		-	0.330	30	✓	piece
HD	VMB400	40	400		-	0.390	30	✓	piece
HD	VMB500	40	500		-	0.460	30	✓	piece
HD	VMB600	40	600		-	0.530	30	✓	piece

To order per full packaging.

Floor bracket and suspension bracket: to mount with VFCL.

Wall bracket: to mount with VFK.

OBZ130

Open suspension bracket

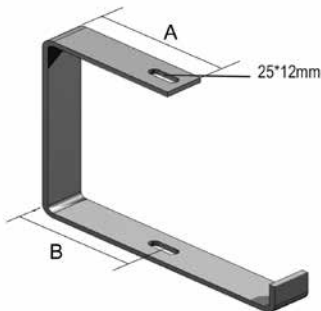

Useful for direct mounting to the ceiling or with threaded rod TIM8 or TIM10.

Standard finish	Electro zinc-plated
Optional finish HD	Hot-dip galvanised
Optional finish PE	Coating

	Max. load (in daN)	A	B
OBZ130.075	80	64	42,5
OBZ130.100	40	80	59,5
OBZ130.150	50	105	84,5
OBZ130.200	30	130	109,5
OBZ130.250	50	155	134,5
OBZ130.300	40	180	159,5
OBZ130.400	30	230	209,5

HD	Reference	↑ mm	↔ mm	↔ mm	↔ mm	kg/piece	📦	Stock	Unit
HD	OBZ130.075	132	102		-	0.390	12	✓	piece
HD	OBZ130.100	132	125		-	0.450	12	✓	piece
HD	OBZ130.150	132	177		-	0.570	12	✓	piece
HD	OBZ130.200	132	227		-	0.670	12	✓	piece
HD	OBZ130.250	132	281		-	1.020	6	✓	piece
HD	OBZ130.300	132	331		-	1.180	6	✓	piece
HD	OBZ130.400	132	431		-	1.600	6	✓	piece

To order per full packaging.

Fixing of the cable tray by VM6.20.

Max. load (in daN): uniformly distributed over complete width of cantilever brackets.

OBZ180

Open suspension bracket

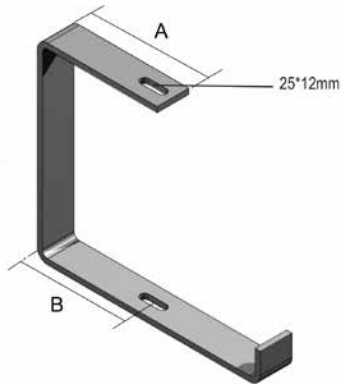

Useful for direct mounting to the ceiling or with threaded rod TIM8 or TIM10.

Standard finish	Electro zinc-plated
Optional finish HD	Hot-dip galvanised
Optional finish PE	Coating

	Max. load (in daN)	A	B
OBZ180.075	50	64	42,5
OBZ180.100	30	80	59,5
OBZ180.150	30	105	84,5
OBZ180.200	30	130	109,5
OBZ180.250	40	155	134,5
OBZ180.300	40	180	159,5
OBZ180.400	20	230	209,5

HD	Reference	↑ mm	↔ mm	↔ mm	↔ mm	kg/piece	📦	Stock	Unit
HD	OBZ180.075	182	102		-	0.460	12	✓	piece
HD	OBZ180.100	182	125		-	0.510	12	✓	piece
HD	OBZ180.150	182	177		-	0.630	12	✓	piece
HD	OBZ180.200	182	227		-	0.720	12	✓	piece
HD	OBZ180.250	182	281		-	1.100	6	✓	piece
HD	OBZ180.300	182	331		-	1.270	6	✓	piece
HD	OBZ180.400	182	431		-	1.500	6	✓	piece

To order per full packaging.

Fixing of the cable tray by VM6.20.

Max. load (in daN): uniformly distributed over complete width of cantilever brackets.

COMEGACLU170

Open suspension bracket universal



Useful for direct mounting to the ceiling or with threaded rod TIM8 or TIM10.

Standard finish	Pre-galvanised
Optional finish HD	Hot-dip galvanised
Optional finish PE	Coating

	Max. load (in daN)	A
COMEGACLU170.150	60	182
COMEGACLU170.200	60	232
COMEGACLU170.300	50	332
COMEGACLU170.400	40	432

HD	Reference	↑ mm	↔ mm	↔ mm	↔ mm	kg/piece	⊞	Stock	Unit
HD	COMEGACLU170.150	170	182		-	0.460	12	✓	piece
HD	COMEGACLU170.200	170	232		-	0.540	12	✓	piece
HD	COMEGACLU170.300	170	332		-	0.700	6	✓	piece
HD	COMEGACLU170.400	170	432		-	0.860	6	✓	piece

To order per full packaging.

Fixing of the cable tray by VM6.10.

Use the VOMEGA to avoid compression of the profile.

Max. load (in daN): uniformly distributed over complete width of cantilever brackets.

Do not use with: VFUL30.065, VFUL35.150, VFU35.150, VFUL 60.050

COMEGACLU290

Open suspension bracket universal



Useful for direct mounting to the ceiling or with threaded rod TIM8 or TIM10.

Standard finish	Pre-galvanised
Optional finish HD	Hot-dip galvanised
Optional finish PE	Coating

	Max. load (in daN)
COMEGACLU290.100	70
COMEGACLU290.150	60
COMEGACLU290.200	60
COMEGACLU290.250	50
COMEGACLU290.300	50
COMEGACLU290.400	40

HD	Reference	↑ mm	↔ mm	↔ mm	↔ mm	kg/piece	⊞	Stock	Unit
HD	COMEGACLU290.100	290	145		-	0.520	12	✓	piece
HD	COMEGACLU290.150	290	195		-	0.560	12	✓	piece
HD	COMEGACLU290.200	290	245		-	0.620	12	✓	piece
HD	COMEGACLU290.250	290	295		-	0.760	6	✓	piece
HD	COMEGACLU290.300	290	345		-	0.820	6	✓	piece
HD	COMEGACLU290.400	290	445		-	0.930	6	✓	piece

To order per full packaging.

Fixing of the cable tray by VM6.10.

Use the VOMEGA to avoid compression of the profile.

Max. load (in daN): uniformly distributed over complete width of cantilever brackets.

Do not use with: VFUL30.065, VFUL35.150, VFU35.150, VFUL 60.050.

CCLI

Bracket for wall, ceiling and cable

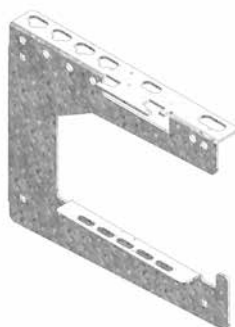

Ideal for installations with wire suspensions.

Also applicable for KBSI, KBS, KGI, KG.

Standard finish	Pre-galvanised
Optional finish PE	Coating

	Max. load (daN) (wall)	Max. load (daN) (ceiling)
CCLI100	80	65
CCLI150	60	45
CCLI200	120	110
CCLI300	130	80
CCLI400	100	60

HD	Reference	↑ mm	↔ mm	↔ mm	↔ mm	kg/piece	⊞	Stock	Unit
-	CCLI100	213	100		-	0.488	6	✓	piece
-	CCLI150	215	150		-	0.594	6	✓	piece
-	CCLI200	218	200		-	0.881	6	✓	piece
-	CCLI300	224	300		-	1.402	6	✓	piece
-	CCLI400	229	400		-	1.784	6	✓	piece

The technical information for this product can be found at the end of this chapter.

To order per full packaging.

Multiple brackets can be mounted one below another.

LOMEGACLU150

Wall bracket universal



Standard finish	Pre-galvanised
Optional finish HD	Hot-dip galvanised
Optional finish PE	Coating

	Max. load (in daN)
LOMEGACLU150.100	110
LOMEGACLU150.150	100
LOMEGACLU150.200	90
LOMEGACLU150.250	80
LOMEGACLU150.300	70
LOMEGACLU150.400	50
LOMEGACLU150.500	40
LOMEGACLU150.600	30

HD	Reference	↑ mm	↔ mm	↔ mm	↔ mm	kg/piece	⊞	Stock	Unit
HD	LOMEGACLU150.100	150	145		-	0.300	12	✓	piece
HD	LOMEGACLU150.150	150	195		-	0.320	12	✓	piece
HD	LOMEGACLU150.200	150	245		-	0.340	12	✓	piece
HD	LOMEGACLU150.250	150	295		-	0.450	12	✓	piece
HD	LOMEGACLU150.300	150	345		-	0.490	12	✓	piece
HD	LOMEGACLU150.400	150	445		-	0.540	6	✓	piece
HD	LOMEGACLU150.500	150	545		-	0.710	6	✓	piece
HD	LOMEGACLU150.600	150	645		-	0.770	6	✓	piece

To order per full packaging.
 Fixing of the cable tray by VM6.10.
 Use the VOMEGA to avoid compression of the profile.
 Max. load (in daN): uniformly distributed over complete width of cantilever brackets.

Do not use with: VFUL30.065, VFUL35.150, VFU35.150, VFUL 60.050.

VOMEGA

Joining piece

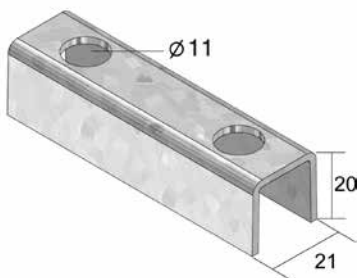

Standard finish	Pre-galvanised
Optional finish HD	Hot-dip galvanised
Optional finish PE	Coating

HD	Reference	↑ mm	↔ mm	↔ mm	↔ mm	kg/piece	⊞	Stock	Unit
HD	VOMEGA	-			-	0.060	48	✓	piece

To order per full packaging.
 For wall mounting 1 piece, for double mounting 2 pieces back to back.

HDMBZ

Wall support

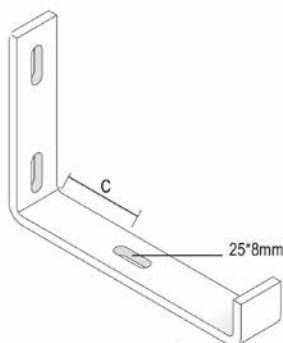

Max. load	40 daN
Standard finish	Hot-dip galvanised
Optional finish PE	Duplex system

	C
HDMBZ075	30
HDMBZ100	47,50
HDMBZ150	65,50
HDMBZ200	97,50

Reference	↑ mm	↔ mm	↔ mm	↔ mm	kg/piece	📦	Stock	Unit
HDMBZ075	120	104		-	0.310	6	✓	piece
HDMBZ100	120	125		-	0.350	6	✓	piece
HDMBZ150	120	175		-	0.470	6	✓	piece
HDMBZ200	120	233		-	0.660	6	✓	piece

To order per full packaging.

WSUN

Universal support bracket

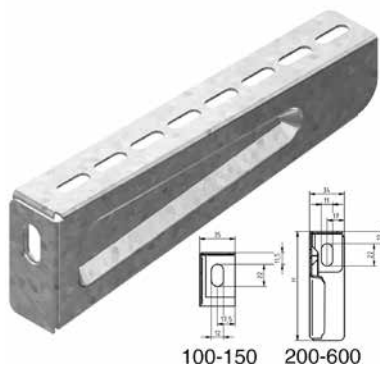

For direct fixing on the wall	
Standard finish	Pre-galvanised
Optional finish HD	Hot-dip galvanised
Optional finish PE	Coating

	Max. load (in daN)
WSUN100	70
WSUN150	60
WSUN200	120
WSUN300	120
WSUN400	120
WSUN500	120
WSUN600	120

HD	Reference	↑ mm	↔ mm	↔ mm	↔ mm	kg/piece	📦	Stock	Unit
HD	WSUN100	53	117		-	0.130	48	✓	piece
HD	WSUN150	59	167		-	0.185	48	✓	piece
HD	WSUN200	69	217		-	0.255	48	✓	piece
HD	WSUN300	81	317		-	0.390	48	✓	piece
HD	WSUN400	93	417		-	0.540	24	✓	piece
HD	WSUN500	106	517		-	0.700	12	✓	piece
HD	WSUN600	118	617		-	0.875	12	✓	piece

The technical information for this product can be found at the end of this chapter.

To order per full packaging.

Max. load (in daN): uniformly distributed over complete width of cantilever brackets.

KCL

Snap-in bracket

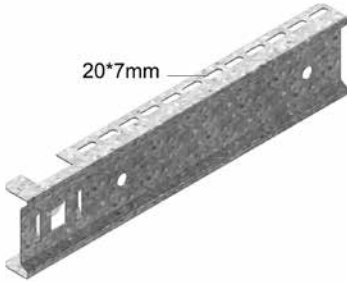

No fixing elements required. For fixing to ceiling profiles HDHSLECL and assembly profile MPCL + KPCL.

Standard finish	Pre-galvanised
-----------------	----------------

	Max. load (in daN)
KCL100	110
KCL150	100
KCL200	100
KCL250	90
KCL300	90
KCL400	70
KCL500	60
KCL600	50

HD	Reference	↑ mm	↔ mm	↔ mm	↔ mm	kg/piece	⊞	Stock	Unit
-	KCL100	80	180		-	0.220	48	✓	piece
-	KCL150	80	230		-	0.300	48	✓	piece
-	KCL200	80	280		-	0.350	48	✓	piece
-	KCL250	80	330		-	0.440	24	✓	piece
-	KCL300	80	380		-	0.470	24	✓	piece
-	KCL400	80	480		-	0.750	24	✓	piece
-	KCL500	80	580		-	0.950	12	✓	piece
-	KCL600	80	680		-	1.130	12	✓	piece

To order per full packaging.

Adapter CLHS for a symmetrical fixing.

Max. load (in daN): uniformly distributed over complete width of cantilever brackets.

WKS

Bolted bracket

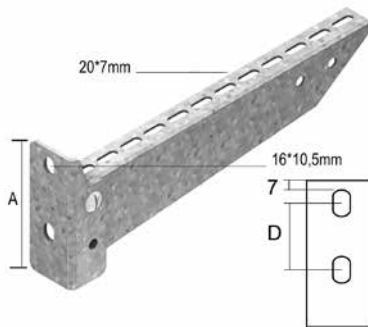

For direct fixing to walls and ceiling profiles

Standard finish	Pre-galvanised
Optional finish HD	Hot-dip galvanised
Optional finish PE	Coating

	Max. load (in daN)	A	D
WKS100	110	99	40
WKS150	110	99	40
WKS200	120	99	40
WKS300	130	119	60
WKS400	130	119	60
WKS500	140	139	80
WKS600	150	139	80

HD	Reference	↑ mm	↔ mm	↔ mm	↔ mm	kg/piece	📦	Stock	Unit
HD	WKS100	99	117		-	0.240	24	✓	piece
HD	WKS150	99	167		-	0.330	24	✓	piece
HD	WKS200	99	217		-	0.380	24	✓	piece
HD	WKS300	119	317		-	0.630	12	✓	piece
HD	WKS400	119	417		-	0.760	12	✓	piece
HD	WKS500	139	517		-	1.000	6	✓	piece
HD	WKS600	139	617		-	1.230	6	✓	piece

To order per full packaging.

For fixing to ceiling profiles, order the necessary fixing elements separately : two sliding nuts GM41M10 and

- bolt B10.20 per bracket for ceiling profile HDHSLECL/HDHSLDCL.

- bolt B10.30 per bracket for ceiling profile HSMES/HSMD.

Max. load (in daN): uniformly distributed over complete width of cantilever brackets.

WKSS

Adjustable bracket

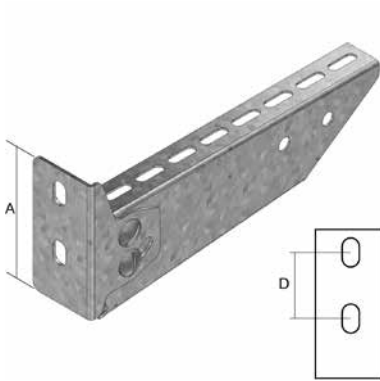

For fixing on the wall and also on the ceiling profile.
Adjustable angle from -20° to +40°.

Standard finish	Pre-galvanised
Optional finish HD	Hot-dip galvanised
Optional finish PE	Coating

	Max. load (in daN)	A	D
WKSS100	110	90	40
WKSS150	110	90	40
WKSS200	120	90	40
WKSS300	100	110	60
WKSS400	75	110	60
WKSS500	60	130	80
WKSS600	50	130	80

HD	Reference	↑ mm	↔ mm	↔ mm	↔ mm	kg/piece	📦	Stock	Unit
HD	WKSS100	90	117		-	0.330	24	✓	piece
HD	WKSS150	90	167		-	0.267	24	✓	piece
HD	WKSS200	90	217		-	0.320	24	✓	piece
HD	WKSS300	110	317		-	0.641	12	✓	piece
HD	WKSS400	110	417		-	0.821	12	✓	piece
HD	WKSS500	130	517		-	1.071	6	✓	piece
HD	WKSS600	130	617		-	1.259	6	✓	piece

To order per full packaging.

HDWK

Welded bracket

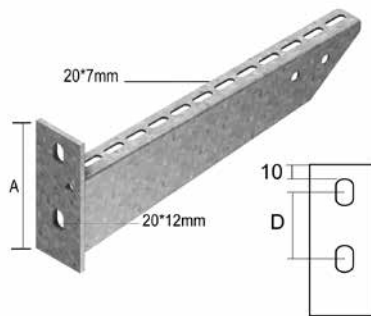

For fixing on the wall and also on the ceiling profile.

Thickness head plate	5 mm
Standard finish	Hot-dip galvanised
Optional finish PE	Duplex system

	Max. load (in daN)	A	D
HDWK100	120	106,5	46,5
HDWK150	230	112	52
HDWK200	340	116	56
HDWK250	450	120,5	60,5
HDWK300	320	125	65
HDWK400	430	134	74
HDWK500	390	142,5	82,5
HDWK600	350	150	90

Reference	↑ mm	↔ mm	↔ mm	↔ mm	kg/piece	📦	Stock	Unit
HDWK100	106	117		-	0.300	24	✓	piece
HDWK150	112	167		-	0.360	24	✓	piece
HDWK200	116	217		-	0.430	24	✓	piece
HDWK250	120	267		-	0.530	12	✓	piece
HDWK300	125	317		-	0.730	12	✓	piece
HDWK400	134	417		-	0.880	12	✓	piece
HDWK500	142	517		-	1.300	6	✓	piece
HDWK600	150	617		-	1.600	6	✓	piece

To order per full packaging.

For fixing on ceiling profiles, order the necessary fixing elements separately: two sliding nuts GM41M10 and

- tapbolt B10.20 per bracket for ceiling profile HDHSLECL/HDHSLDCL.
- tapbolt B10.30 per bracket for ceiling profile HSMES/HSMD.

Max. load (in daN): uniformly distributed over complete width of cantilever brackets.

WKCL

Snap-in bracket for MP-profile or MBWK

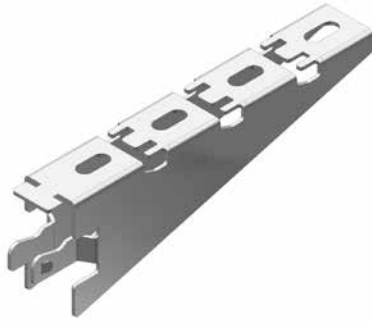

Ideal in combination with ceiling profile HSLE3 and perforated MP-profile.

Standard finish	Pre-galvanised
Optional finish HD	Hot-dip galvanised

	Max. load (daN) HSLE3
WKCL100	190
WKCL150	190
WKCL200	160
WKCL300	125
WKCL400	90
WKCL500	70

HD	Reference	↑ mm	↔ mm	↔ mm	↔ mm	kg/piece	⊞	Stock	Unit
HD	WKCL100	65	100		-	0.229	12	✓	piece
HD	WKCL150	65	150		-	0.294	12	✓	piece
HD	WKCL200	65	200		-	0.334	12	✓	piece
HD	WKCL300	65	300		-	0.464	12	✓	piece
HD	WKCL400	65	400		-	0.604	12	✓	piece
HD	WKCL500	65	400		-	0.744	12	✓	piece

The technical information for this product can be found at the end of this chapter.

To order per full packaging.

Max. load (in daN): uniformly distributed over complete width of cantilever brackets.

5

WKMP41.21

Bolt-on wall bracket MP41.21

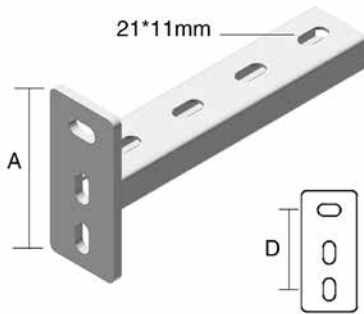

Standard finish	Electro zinc-plated
Optional finish HD	Hot-dip galvanised
Optional finish PE	Duplex system

	Max. load (in daN)	A	D
WKMP41.21.150	380	112	74
WKMP41.21.200	250	112	74
WKMP41.21.300	160	112	74

HD	Reference	↑ mm	↔ mm	↔ mm	↔ mm	kg/piece	⊞	Stock	Unit
HD	WKMP41.21.150	112	150		-	0.450	12	✓	piece
HD	WKMP41.21.200	112	200		-	0.550	12	✓	piece
HD	WKMP41.21.300	112	300		-	0.650	1	✓	piece

To order per full packaging.

Max. load (in daN): uniformly distributed over complete width of cantilever brackets.

WKMPCL41.21

Bolt-on wall bracket MP41.21

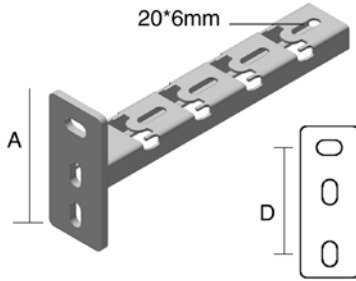

Standard finish

Electro zinc-plated

Optional finish HD

Hot-dip galvanised

	Max. load (in daN)	A	D
WKMPCL41.21.150	160	112	74
WKMPCL41.21.200	90	112	74
WKMPCL41.21.300	40	112	74

HD	Reference	↑ mm	↔ mm	↗ mm	↖ mm	kg/piece	📦	Stock	Unit
HD	WKMPCL41.21.150	112	200		-	0.450	12		piece
HD	WKMPCL41.21.200	112	250		-	0.550	12		piece
HD	WKMPCL41.21.300	112	350		-	0.650	1		piece

To order per full packaging.

WKMP41.41

Bolt-on wall bracket MP41.41

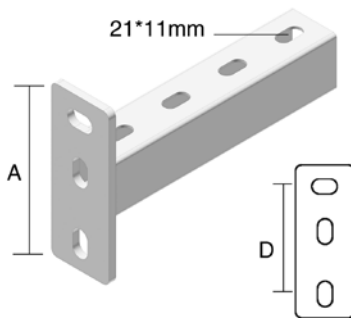

Standard finish

Electro zinc-plated

Optional finish HD

Hot-dip galvanised

	Max. load (in daN)	A	D
WKMP41.41.300	500	132	93
WKMP41.41.400	350	132	93
WKMP41.41.500	275	132	93
WKMP41.41.600	200	132	93
WKMP41.41.750	180	132	93
WKMP41.41.1000	130	132	93

HD	Reference	↑ mm	↔ mm	↗ mm	↖ mm	kg/piece	📦	Stock	Unit
HD	WKMP41.41.300	132	300		-	0.900	1	✓	piece
HD	WKMP41.41.400	132	400		-	1.100	1	✓	piece
HD	WKMP41.41.500	132	500		-	1.300	1	✓	piece
HD	WKMP41.41.600	132	600		-	1.500	1	✓	piece
HD	WKMP41.41.750	132	750		-	1.800	1	✓	piece
HD	WKMP41.41.1000	132	1000		-	2.300	1	✓	piece

To order per full packaging.

Max. load (in daN): uniformly distributed over complete width of cantilever brackets.

WKMPCL41.41

Universal wall bracket MP41.41

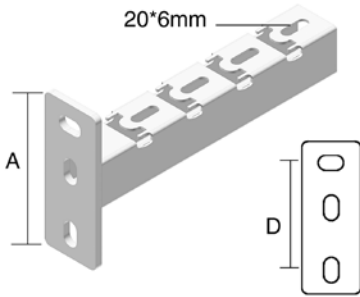

Standard finish

Electro zinc-plated

Optional finish HD

Hot-dip galvanised

	Max. load (in daN)	A	D
WKMPCL41.41.300	265	132	93
WKMPCL41.41.400	235	132	93
WKMPCL41.41.500	190	132	93
WKMPCL41.41.600	120	132	93

HD	Reference	↑ mm	↔ mm	↔ mm	↔ mm	kg/piece	⊞	Stock	Unit
HD	WKMPCL41.41.300	132	350		-	0.970	1	✓	piece
HD	WKMPCL41.41.400	132	450		-	1.090	1	✓	piece
HD	WKMPCL41.41.500	132	550		-	1.220	1	✓	piece
HD	WKMPCL41.41.600	132	650		-	1.340	1	✓	piece

The technical information for this product can be found at the end of this chapter.

To order per full packaging.

Max. load (in daN): uniformly distributed over complete width of cantilever brackets.

WKUMP41.41

Bolt-on bracket MP41.41 for ceil. prof.

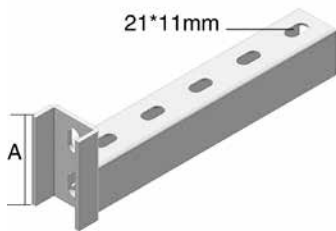

Standard finish

Electro zinc-plated

Optional finish HD

Hot-dip galvanised

	Max. load (in daN)	A
WKUMP41.41.300	400	80
WKUMP41.41.400	300	80
WKUMP41.41.500	240	80
WKUMP41.41.600	175	80
WKUMP41.41.750	160	80
WKUMP41.41.1000	90	80

HD	Reference	↑ mm	↔ mm	↔ mm	↔ mm	kg/piece	⊞	Stock	Unit
HD	WKUMP41.41.300	80	300		-	0.900	1	✓	piece
HD	WKUMP41.41.400	80	400		-	1.100	1	✓	piece
HD	WKUMP41.41.500	80	500		-	1.300	1	✓	piece
HD	WKUMP41.41.600	80	600		-	1.500	1	✓	piece
HD	WKUMP41.41.750	80	750		-	1.800	1	✓	piece
HD	WKUMP41.41.1000	80	1000		-	2.300	1	✓	piece

To order per full packaging.

Max. load (in daN): uniformly distributed over complete width of cantilever brackets.

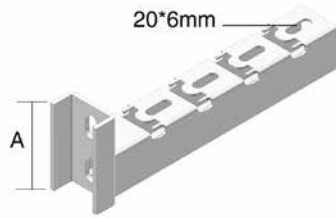
WKUMPCL41.41**Universal bracket MP41.41 for ceil. prof**

Standard finish

Electro zinc-plated

Optional finish HD

Hot-dip galvanised

	Max. load (in daN)	A
WKUMPCL41.41.150	550	80
WKUMPCL41.41.200	550	80
WKUMPCL41.41.300	265	80
WKUMPCL41.41.400	235	80
WKUMPCL41.41.500	190	80
WKUMPCL41.41.600	120	80

HD	Reference	↑ mm	↔ mm	↔ mm	↔ mm	kg/piece	⊞	Stock	Unit
HD	WKUMPCL41.41.150	80	200		-	0.520	12	✓	piece
HD	WKUMPCL41.41.200	80	250		-	0.840	12	✓	piece
HD	WKUMPCL41.41.300	80	350		-	0.970	1	✓	piece
HD	WKUMPCL41.41.400	80	450		-	1.090	1	✓	piece
HD	WKUMPCL41.41.500	80	550		-	1.220	1	✓	piece
HD	WKUMPCL41.41.600	80	650		-	1.340	1	✓	piece

The technical information for this product can be found at the end of this chapter.

To order per full packaging.

Max. load (in daN): uniformly distributed over complete width of cantilever brackets.

HDWKM

Heavy welded bracket

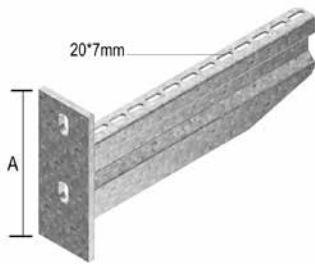

For fixing on the wall and also on the ceiling profile.

Standard finish	Hot-dip galvanised
Optional finish PE	Duplex system

	Max. load (in daN)
HDWKM100	600
HDWKM200	620
HDWKM300	750
HDWKM400	750
HDWKM500	700
HDWKM600	580
HDWKM800	320
HDWKM1000	250

Reference	↑ mm	↔ mm	↔ mm	↔ mm	kg/piece	⊞	Stock	Unit
HDWKM100	125	125		-	0.450	24	✓	piece
HDWKM200	134	225		-	0.650	24	✓	piece
HDWKM300	175	325		-	1.377	6	✓	piece
HDWKM400	175	425		-	1.696	6	✓	piece
HDWKM500	175	525		-	2.014	1	✓	piece
HDWKM600	175	625		-	2.332	1	✓	piece
HDWKM800	175	825		-	2.969	1	✓	piece
HDWKM1000	175	1025		-	3.606	1	✓	piece

The technical information for this product can be found at the end of this chapter.

To order per full packaging.

Max. load (in daN): uniformly distributed over complete width of cantilever brackets.

HDWKMD

Heavy welded double bracket

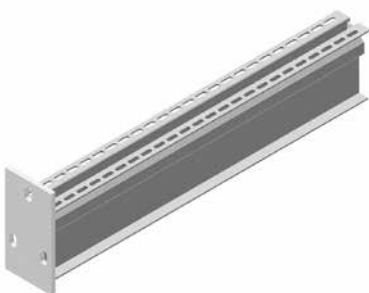

For fixing on the wall and also on the ceiling profile.

Standard finish	Hot-dip galvanised
Optional finish PE	Duplex system

	Max. load (in daN)
HDWKMD500	1500
HDWKMD600	1300
HDWKMD800	950
HDWKMD1000	750

Reference	↑ mm	↔ mm	↔ mm	↔ mm	kg/piece	⊞	Stock	Unit
HDWKMD500	170	525		-	4.279	1	✓	piece
HDWKMD600	170	625		-	4.915	1	✓	piece
HDWKMD800	170	825		-	6.186	1	✓	piece
HDWKMD1000	170	1025		-	7.463	1	✓	piece

The technical information for this product can be found at the end of this chapter.

Max. load (in daN): uniformly distributed over complete width of cantilever brackets.

HDHKI

Welded clamping bracket

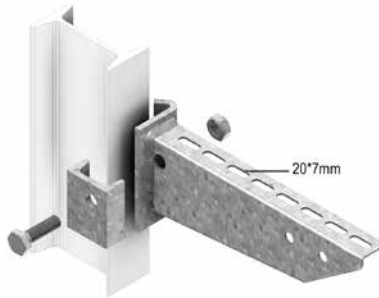

For fixing to ceiling profiles HDHSIZ and HDIPE80S

Standard finish	Hot-dip galvanised
Optional finish PE	Duplex system

	Max. Load (in daN)
HDHKI100	300
HDHKI150	300
HDHKI200	300
HDHKI250	330
HDHKI300	330
HDHKI400	310
HDHKI500	310
HDHKI600	300

Reference	↑ mm	↔ mm	↔ mm	↔ mm	kg/piece	📦	Stock	Unit
HDHKI100	90	117	-	-	0.300	24	✓	piece
HDHKI150	90	167	-	-	0.370	24	✓	piece
HDHKI200	90	217	-	-	0.500	24	✓	piece
HDHKI250	100	267	-	-	0.460	12	✓	piece
HDHKI300	100	317	-	-	0.690	12	✓	piece
HDHKI400	117	417	-	-	0.850	12	✓	piece
HDHKI500	117	517	-	-	1.350	6	✓	piece
HDHKI600	117	617	-	-	1.550	6	✓	piece

Welded headplate.

Included: clamp plate, bolt HDB10.40 and nut HDM10.

Max. load (in daN): uniformly distributed over complete width of cantilever brackets.

HDUKPIZ

Universal adapter

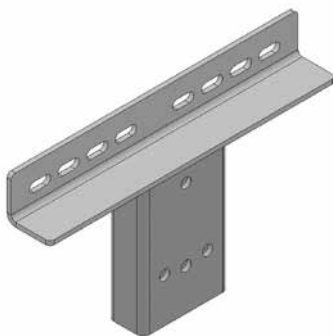

Universal adapter for wall and I-profile.

Standard finish	Hot-dip galvanised
Optional finish PE	Duplex system

Reference	↑ mm	↔ mm	↔ mm	↔ mm	kg/piece	📦	Stock	Unit
HDUKPIZ	245	400	-	-	3.916	1		piece

The technical information for this product can be found at the end of this chapter.

Targets use with HDWKMD and HDWKM wall mounts.

Can also be used with HDWK, WKSS and WSUN wall mounts.

Can be mounted on I-profiles between 80 and 300mm.

When mounting on the on the flange of the I-profile HDVS41.47 clamps, HDB12.60 bolts, HDM12 nuts and HDCRO12 washers should be used.

HDHKIZ

Extra heavy duty welded clamping bracket

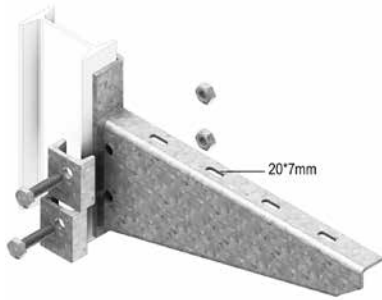

For fixing to ceiling profiles HDHSIZ and HDIPE80S

Thickness head plate	5 mm
Standard finish	Hot-dip galvanised
Optional finish PE	Duplex system

	Max. load (in daN)
HDHKIZ300	900
HDHKIZ400	910
HDHKIZ500	920
HDHKIZ600	930

Reference	↑ mm	↔ mm	↔ mm	↔ mm	kg/piece	⊞	Stock	Unit
HDHKIZ300	175	325		-	1.300	1	✓	piece
HDHKIZ400	200	425		-	1.700	1	✓	piece
HDHKIZ500	230	525		-	2.250	1	✓	piece
HDHKIZ600	260	625		-	3.050	1	✓	piece

Headplate is welded.

Included: 2x clamp plate, 2x bolt HDB10.40 and 2x nut HDM10.

Max. load (in daN): uniformly distributed over complete width of cantilever brackets.

KPCL

Clippable headplate

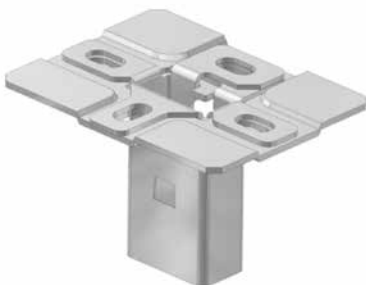

Clippable headplate for ceiling profile

Max. load	300 daN
Standard finish	Pre-galvanised

HD	Reference	↑ mm	↔ mm	↔ mm	↔ mm	kg/piece	⊞	Stock	Unit
-	KPCL41.21	84	130		-	0.530	10	✓	piece

To order per full packaging.

Innovative and low cost.

Tested according to CEI/IEC 61537.

The end plate should always be fixed with the supplied supporting plate.

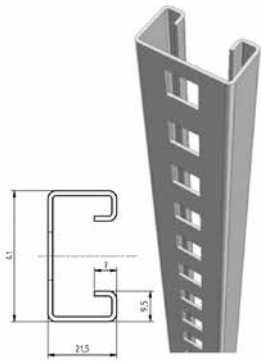
MPCL41.21**Clippable assembly profile**

Ideal in combination with the KCL support bracket.

Standard finish

Pre-galvanised

HD	Reference	↑ mm	↔ mm	↗ mm	↘ mm	kg/piece	📦	Stock	Unit
-	MPCL41.21.150.200	41	21	1.50	210	0.240	10	✓	piece
-	MPCL41.21.150.300	41	21	1.50	300	0.340	10	✓	piece
-	MPCL41.21.150.400	41	21	1.50	420	0.480	10	✓	piece
-	MPCL41.21.150.500	41	21	1.50	510	0.580	10	✓	piece
-	MPCL41.21.150.600	41	21	1.50	600	0.680	10	✓	piece
-	MPCL41.21.150.800	41	21	1.50	810	0.920	10	✓	piece
-	MPCL41.21.150.3	41	21	1.50	3000	1.150	3	✓	m

To order per full packaging.

Is preassembled with support brackets, the resulting assembly clips into the KPCL.
Fix the KPCL to the ceiling, then slide in the profile locking it in place.

Protection cap in yellow PVC: DOP41.21

HDHSLECL

Single ceiling profile clippable



Ceiling profile: HDMP41.21
Welded headplate: 120x120 mm

Max. load	1000 daN
Thickness head plate	4 mm
Standard finish	Hot-dip galvanised
Optional finish PE	Duplex system

Reference	↑ mm	↔ mm	↔ mm	↔ mm	kg/piece	⊞	Stock	Unit
HDHSLECL200	-			210	0.740	25	✓	piece
HDHSLECL300	-			300	0.850	1	✓	piece
HDHSLECL400	-			420	1.010	1	✓	piece
HDHSLECL500	-			510	1.130	1	✓	piece
HDHSLECL600	-			600	1.230	1	✓	piece
HDHSLECL800	-			810	1.450	1	✓	piece
HDHSLECL1000	-			1020	1.750	1	✓	piece
HDHSLECL1200	-			1200	1.950	1	✓	piece

The technical information for this product can be found at the end of this chapter.

For single and double sided fixing of the bracket KCL and for single sided fixing of the other brackets WKS and HDWK using sliding nut GM41M10 and hexagonal bolt B10.20.
Protection cap in yellow PVC: DOP41.21.

CLHS

Snap-in adapter for HDHSLECL



Standard finish		Pre-galvanised							
HD	Reference	↑ mm	↔ mm	↔ mm	↔ mm	kg/piece	⊞	Stock	Unit
-	CLHS	-			-	0.120	24	✓	piece

To order per full packaging.

HDHSLDCL

Double ceiling profile



Ceiling profile: HDMP41.21
Welded headplate: 120x120 mm

Max. load	1800 daN
Thickness head plate	4 mm
Standard finish	Hot-dip galvanised
Optional finish PE	Duplex system

Reference	↑ mm	↔ mm	↔ mm	↔ mm	kg/piece	📦	Stock	Unit
HDHSLDCL200	-			210	1.000	20	✓	piece
HDHSLDCL300	-			300	1.230	1	✓	piece
HDHSLDCL400	-			420	1.480	1	✓	piece
HDHSLDCL500	-			510	1.700	1	✓	piece
HDHSLDCL600	-			600	1.900	1	✓	piece
HDHSLDCL800	-			810	2.250	1	✓	piece
HDHSLDCL1000	-			1020	2.900	1	✓	piece
HDHSLDCL1200	-			1200	3.340	1	✓	piece

The technical information for this product can be found at the end of this chapter.

For single and double sided fixing of brackets WKS and HDWK.

Use sliding nut GM41M10 and hexagonal bolt B10.20.

Protection cap in yellow PVC : DOP41.41.

HSLE3

Single ceiling profile perfo 3 sides



Ceiling profile: MP3.41.41
Welded headplate: 135x135 mm

Max. load	1800 daN
Thickness head plate	5 mm
Standard finish	Electro zinc-plated
Optional finish HD	Hot-dip galvanised

HD	Reference	↑ mm	↔ mm	↔ mm	↔ mm	kg/piece	📦	Stock	Unit
HD	HSLE3.300	-			300	0.970	1	✓	piece
HD	HSLE3.400	-			400	1.090	1	✓	piece
HD	HSLE3.500	-			500	1.220	1	✓	piece
HD	HSLE3.600	-			600	1.340	1	✓	piece
HD	HSLE3.700	-			700	1.470	1	✓	piece
HD	HSLE3.800	-			800	1.590	1	✓	piece
HD	HSLE3.900	-			900	1.720	1	✓	piece
HD	HSLE3.1000	-			1000	1.840	1	✓	piece
HD	HSLE3.1200	-			1200	2.090	1	✓	piece
HD	HSLE3.1500	-			1500	2.470	1	✓	piece

The technical information for this product can be found at the end of this chapter.

To mount on 4 sides: 3 sides via slots through bracket WKCL , 4th side where one can fix with a sliding nut GM41M10 and hexagonal bolt B10.30.

Protection cap in yellow PVC: DOP41.41.

HSMES

Single ceiling profile

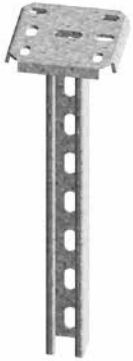

Ceiling profile: MP41.41S
Welded headplate: 120x120 mm

Max. load	1800 daN
Standard finish	Electro zinc-plated
Optional finish HD	Hot-dip galvanised
Optional finish PE	Coating

HD	Reference	↑ mm	↔ mm	↔ mm	↔ mm	kg/piece	📦	Stock	Unit
HD	HSMES200	-			200	1.020	20	✓	piece
HD	HSMES300	-			300	1.280	1	✓	piece
HD	HSMES400	-			400	1.530	1	✓	piece
HD	HSMES500	-			500	1.790	1	✓	piece
HD	HSMES600	-			600	2.050	1	✓	piece
HD	HSMES800	-			800	2.570	1	✓	piece
HD	HSMES1000	-			1000	3.090	1	✓	piece
HD	HSMES1200	-			1200	3.600	1	✓	piece
HD	HSMES1500	-			1500	4.380	1	✓	piece

Also applicable for double mounting.
Use sliding nut GM41M10 and hexagonal bolt B10.30.
Protection cap in yellow PVC: DOP41.41.

HSMD

Double ceiling profile

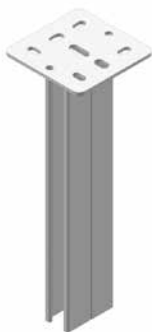

2x ceiling profile: MP41.41
Welded headplate: 135x135 mm

Max. load	3500 daN
Thickness head plate	5 mm
Standard finish	Electro zinc-plated
Optional finish HD	Hot-dip galvanised
Optional finish PE	Coating

HD	Reference	↑ mm	↔ mm	↔ mm	↔ mm	kg/piece	⊞	Stock	Unit
HD	HSMD200	-			200	1.600	15	✓	piece
HD	HSMD300	-			300	2.150	1	✓	piece
HD	HSMD400	-			400	2.650	1	✓	piece
HD	HSMD500	-			500	3.300	1	✓	piece
HD	HSMD600	-			600	3.900	1	✓	piece

The technical information for this product can be found at the end of this chapter.

For single and double sided fixing of brackets.
Use sliding nut GM41M10 and hexagonal bolt B10.30.
Protection cap in yellow PVC: DOP41.82

HDHSMD

Double ceiling profile

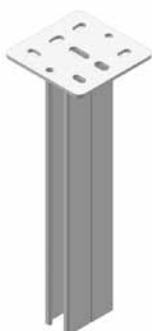

2x ceiling profile: MP41.41
Welded headplate: 135x135 mm

Max. load	3500 daN
Thickness head plate	5 mm
Standard finish	Hot-dip galvanised
Optional finish PE	Duplex system

Reference	↑ mm	↔ mm	↔ mm	↔ mm	kg/piece	⊞	Stock	Unit
HDHSMD800	-			800	4.900	1	✓	piece
HDHSMD1000	-			1000	6.000	1	✓	piece
HDHSMD1200	-			1200	7.200	1	✓	piece
HDHSMD1500	-			1500	9.000	1	✓	piece

For single and double sided fixing of brackets.
Use sliding nut GM41M10 and hexagonal bolt B10.30.
Protection cap in yellow PVC: DOP41.82.

HDHSMU50

Ceiling profile medium heavy

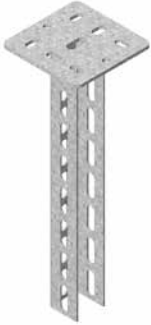

Max. load	2100 daN
Standard finish	Hot-dip galvanised
Optional finish PE	Duplex system

Reference	↑ mm	↔ mm	↔ mm	↔ mm	kg/piece	⊞	Stock	Unit
HDHSMU50.200	-			200	0.940	1	✓	piece
HDHSMU50.300	-			300	1.160	1	✓	piece
HDHSMU50.400	-			400	1.380	1	✓	piece
HDHSMU50.500	-			500	1.610	1	✓	piece
HDHSMU50.600	-			600	1.830	1	✓	piece
HDHSMU50.800	-			800	2.270	1	✓	piece
HDHSMU50.1000	-			1000	2.710	1	✓	piece
HDHSMU50.1200	-			1200	3.150	1	✓	piece
HDHSMU50.1500	-			1500	3.820	1	✓	piece

The technical information for this product can be found at the end of this chapter.

HDTSU

Spacer for HDHSMU50



Standard finish	Hot-dip galvanised
-----------------	--------------------

Reference	↑ mm	↔ mm	↔ mm	↔ mm	kg/piece	⊞	Stock	Unit
HDTSU50	-			-	0.223	12	✓	piece

The technical information for this product can be found at the end of this chapter.

To order per full packaging.

Included: bolt HDB10.80, HDCRO10 and nuts HDM10.

HDHSIZ

Heavy ceiling profile

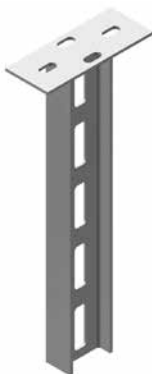

Ceiling profile: HDIPE80S
Welded headplate: 80x200 mm

Max. load	2940 daN
Thickness head plate	5 mm
Standard finish	Hot-dip galvanised
Optional finish PE	Duplex system

Reference	↑ mm	↔ mm	↔ mm	↔ mm	kg/piece	📦	Stock	Unit
HDHSIZ200	-			200	1.800	1	✓	piece
HDHSIZ400	-			400	3.050	1	✓	piece
HDHSIZ500	-			500	3.600	1	✓	piece
HDHSIZ600	-			600	4.200	1	✓	piece
HDHSIZ800	-			800	5.500	1	✓	piece
HDHSIZ1000	-			1000	6.700	1	✓	piece
HDHSIZ1200	-			1200	8.000	1	✓	piece
HDHSIZ1500	-			1500	9.900	1	✓	piece
HDHSIZ1800	-			1800	12.000	1	✓	piece
HDHSIZ2000	-			2000	13.300	1	✓	piece

The technical information for this product can be found at the end of this chapter.

For double sided fixing of clamping brackets HDHKI and HDHKIZ.

Application: as ceiling or floor support.

Protection cap in yellow PVC: DOPIPE80.

DOP41.21

End cap for MP41.21

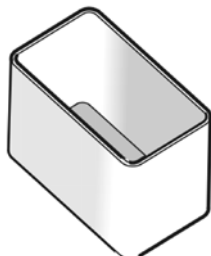

Color	yellow
Standard finish	Polyvinyl chloride

HD	Reference	↑ mm	↔ mm	↔ mm	↔ mm	kg/piece	📦	Stock	Unit
-	DOP41.21	26	41		21	0.010	50	✓	piece

To order per full packaging.

DOP41.41

End cap for MP41.41

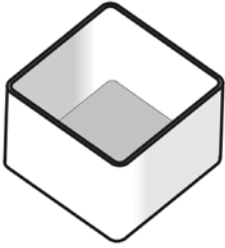

Color	yellow
Standard finish	Polyvinyl chloride

HD	Reference	mm	mm	mm	mm	kg/piece		Stock	Unit
-	DOP41.41	26	41		41	0.010	50	✓	piece

To order per full packaging.

DOP41.82

End cap for MP41.82

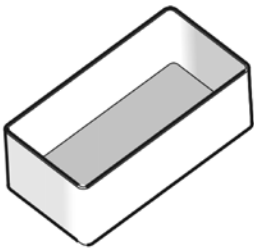

Color	yellow
Standard finish	Polyvinyl chloride

HD	Reference	mm	mm	mm	mm	kg/piece		Stock	Unit
-	DOP41.82	26	41		82	0.020	50	✓	piece

To order per full packaging.

DOPHSMU

Protection cap for HSMU50



Color	yellow
Standard finish	Polyvinyl chloride

HD	Reference	mm	mm	mm	mm	kg/piece		Stock	Unit
-	DOPHSMU	26			50	0.017	50	✓	piece

To order per full packaging.

HDSKP

Adjustable head plate

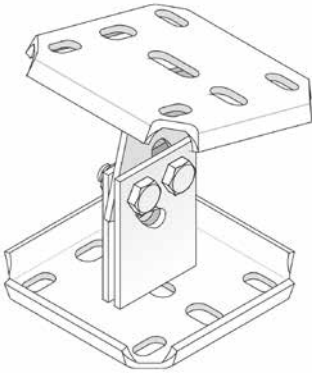

Welded headplate: 120x120 mm

Max. load 1200 daN

Standard finish Hot-dip galvanised

Reference	↑ mm	↔ mm	↔ mm	↔ mm	kg/piece	📦	Stock	Unit
HDSKP	-	120		120	1.300	12	✓	piece

The technical information for this product can be found at the end of this chapter.

Ideal for fixing on sloping ceilings with 4 bolts HDB10x20 and 4 screws HDM10, max. angle of 60°.

HDPIPE80S

Perforated I-profile

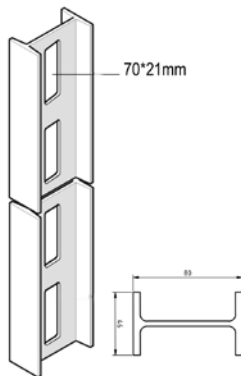

Standard finish Hot-dip galvanised

Optional finish PE Duplex system

Reference	↑ mm	↔ mm	↔ mm	↔ mm	kg/m	📦	Stock	Unit
HDPIPE80S	80	46		6000	5.610	6	✓	m

Moment of resistance: $W_x = 19.50 \text{ cm}^3$.
Protection cap in yellow PVC: DOPIPE80.

DOPIPE80

End cap for HDIPE80S

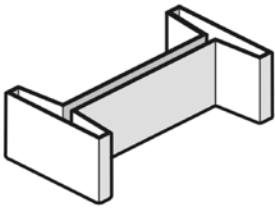

Color	yellow
Standard finish	Polyvinyl chloride

HD	Reference	↑ mm	↔ mm	↔ mm	↔ mm	kg/piece	⊞	Stock	Unit
-	DOPIPE80	26	80			0.020	12	✓	piece

To order per full packaging.

HDIPL06

Headplate for HDIPE80S



Max. load	3500 daN
Thickness head plate	5 mm
Standard finish	Hot-dip galvanised
Optional finish PE	Duplex system

Reference	↑ mm	↔ mm	↔ mm	↔ mm	kg/piece	⊞	Stock	Unit
HDIPL06	185	80			1.422	6	✓	piece

The technical information for this product can be found at the end of this chapter.

To order per full packaging.

To be fixed on HDIPE80S with 2 bolts HDB12.40 and nuts HDM12.

HDIPL10

Headplate for HDIPE80S

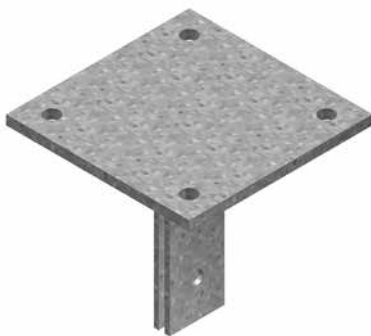

Max. load	4400 daN
Thickness head plate	10 mm
Standard finish	Hot-dip galvanised
Optional finish PE	Duplex system

Reference	↑ mm	↔ mm	↔ mm	↔ mm	kg/piece	⊞	Stock	Unit
HDIPL10	190	200			3.910	1	✓	piece

The technical information for this product can be found at the end of this chapter.

To be fixed on HDIPE80S with 2 bolts HDB12.40 and nuts HDM12.

HDSKIPE

Hinged headplate for HDIPE80S

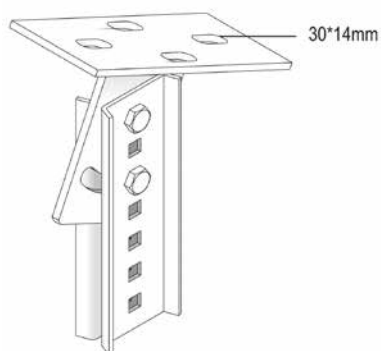

To be mounted on HDIPE80S profile, max. angle of 35°.

Max. load	2350 daN
Standard finish	Hot-dip galvanised
Optional finish PE	Duplex system

Reference	↑ mm	↔ mm	↔ mm	↔ mm	kg/piece	📦	Stock	Unit
HDSKIPE	-		3.00	191	1.670	6	✓	piece

The technical information for this product can be found at the end of this chapter.

To order per full packaging.

Included: 2x HDKPIPE, 2x bolt HDB10.30, 2x nut HDM10 and 2x HDRO10.

HDKPIPE

Joining piece for HDIPE80S



To joint straighten HDIPE80S profiles.

Standard finish	Hot-dip galvanised
Optional finish PE	Duplex system

Reference	↑ mm	↔ mm	↔ mm	↔ mm	kg/piece	📦	Stock	Unit
HDKPIPE	67		3.00	191	0.370	6	✓	piece

Fix with:

-	HDB10.30	-	-	M10	30	0.027	100		piece
-	HDM10	-	-	M10	-	0.010	100	✓	piece
-	HDRO10	-	-	10.00	-	0.004	100	✓	piece

To order per full packaging.

HDDKIPE

Cross joiner for HDIPE80S

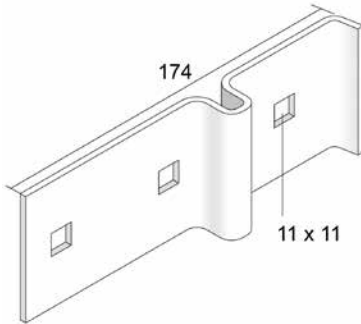

To joint squarely 2 HDIPE80S profiles.

Standard finish	Hot-dip galvanised
Optional finish PE	Duplex system

Reference	↑ mm	↔ mm	↔ mm	↔ mm	kg/piece	⊞	Stock	Unit
HDDKIPE	60		3.00	-	0.270	6	✓	piece
Fix with:								
- HDB10.30	-	-	M10	30	0.027	100		piece
- HDM10	-	-	M10	-	0.010	100	✓	piece
- HDRO10	-	-	10.00	-	0.004	100	✓	piece

To order per full packaging.

HDKIPE

Mounting piece HDIPE80S

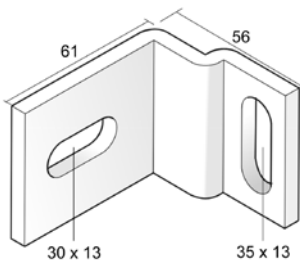

To fix the HDIPE80S profile on the wall.

Standard finish	Hot-dip galvanised
Optional finish PE	Duplex system

Reference	↑ mm	↔ mm	↔ mm	↔ mm	kg/piece	⊞	Stock	Unit
HDKIPE	-		6.00	-	0.240	6	✓	piece

To order per full packaging.

HDWVPIPE

Bolted bracket

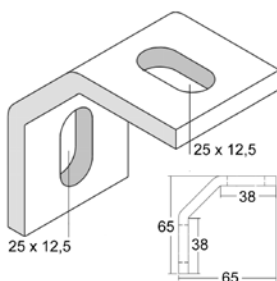

Standard finish	Hot-dip galvanised
Optional finish PE	Duplex system

Reference	↑ mm	↔ mm	↔ mm	↔ mm	kg/piece	⊞	Stock	Unit
HDWVPIPE	65	65	6.50	-	0.190	50	✓	piece

To order per full packaging.

L25

L-profile

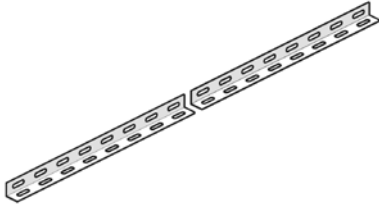

Groove holes of 25x7 mm with intervals of 50 mm

Standard finish	Pre-galvanised
Optional finish HD	Hot-dip galvanised
Optional finish PE	Coating

HD	Reference	↑ mm	↔ mm	↔ mm	↔ mm	kg/m	⊞	Stock	Unit
HD	L25.125	25	25	1.25	3000	0.400	3		m
HD	L25.200	25	25	2.00	3000	0.670	3		m

L25.50

L-profile

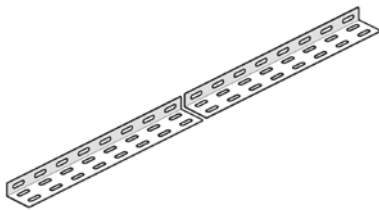

Groove holes of 25x7 mm with intervals of 50 mm

Standard finish	Pre-galvanised
Optional finish HD	Hot-dip galvanised
Optional finish PE	Coating

HD	Reference	↑ mm	↔ mm	↔ mm	↔ mm	kg/m	⊞	Stock	Unit
HD	L25.50.125	25	50	1.25	3000	0.820	3		m
HD	L25.50.200	25	50	2.00	3000	1.000	3		m

L50.50

L-profile

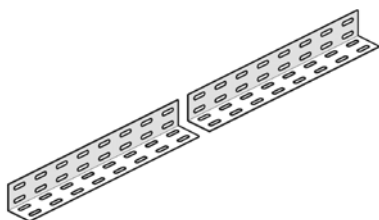

Groove holes of 25x7 mm with intervals of 50 mm

Standard finish	Pre-galvanised
Optional finish HD	Hot-dip galvanised
Optional finish PE	Coating

HD	Reference	↑ mm	↔ mm	↔ mm	↔ mm	kg/m	⊞	Stock	Unit
HD	L50.50.125	50	50	1.25	3000	0.800	3		m
HD	L50.50.200	50	50	2.00	3000	1.330	3		m

Z25

Z-profile

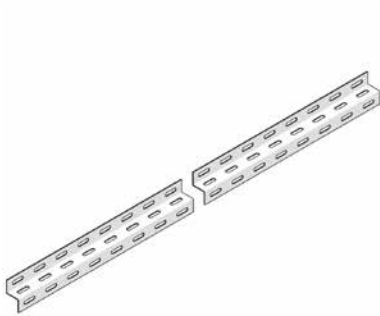

Groove holes of 25x7 mm with intervals of 50 mm

Standard finish	Pre-galvanised
Optional finish HD	Hot-dip galvanised
Optional finish PE	Coating

HD	Reference	↑ mm	↔ mm	↔ mm	↔ mm	kg/m	⊞	Stock	Unit
HD	Z25.25.25.125	50	25	1.25	3000	0.730	3		m

The technical information for this product can be found at the end of this chapter.

Z50

Z-profile

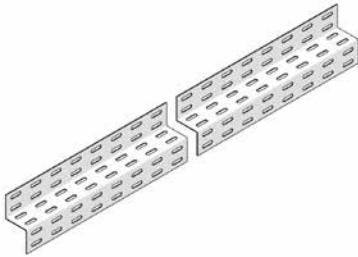

Groove holes of 25x7 mm with intervals of 50 mm

Standard finish	Pre-galvanised
Optional finish HD	Hot-dip galvanised
Optional finish PE	Coating

HD	Reference	↑ mm	↔ mm	↔ mm	↔ mm	kg/m	⊞	Stock	Unit
HD	Z50.50.50.125	100	50	1.25	3000	1.520	3		m

U24

U-profile 24

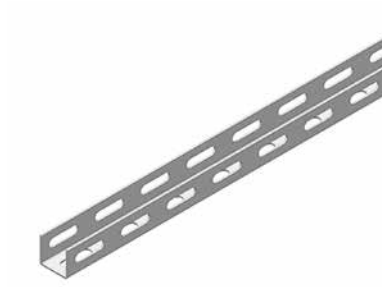

Standard finish

Pre-galvanised

Optional finish HD

Hot-dip galvanised

HD	Reference	↑ mm	↔ mm	↔ mm	↔ mm	kg/m	📦	Stock	Unit
HD	U24.125	24	24	1.25	3000	0.682	3		m

U48

U-profile 48

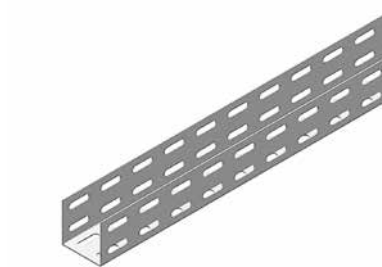

Standard finish

Pre-galvanised

Optional finish HD

Hot-dip galvanised

HD	Reference	↑ mm	↔ mm	↔ mm	↔ mm	kg/m	📦	Stock	Unit
HD	U48.125	48	48	1.25	3000	1.372	3	✓	m

MP41.21

Assembly profile

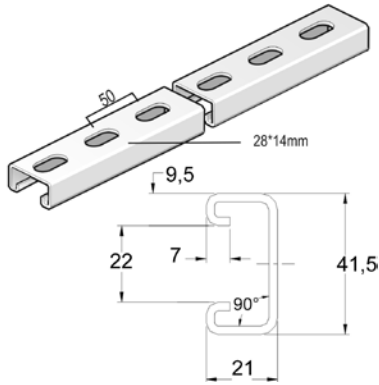

Profile opening	22 mm
Standard finish	Pre-galvanised
Optional finish PE	Coating

HD	Reference	↑ mm	↔ mm	↔ mm	↔ mm	kg/m	⊞	Stock	Unit
-	MP41.21.150.3S	41	21	1.50	3000	1.220	3	✓	m
-	MP41.21.250.3S	41	21	2.50	3000	1.750	3	✓	m
-	MP41.21.250.6S	41	21	2.50	6000	1.750	6	✓	m

HDMP41.21

Assembly profile

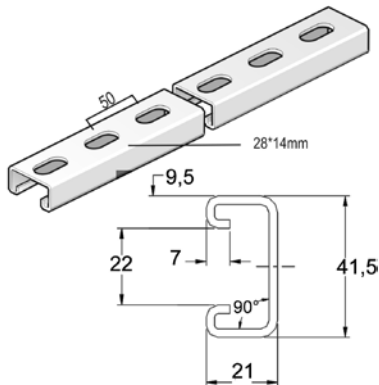

Profile opening	22 mm
Standard finish	Hot-dip galvanised
Optional finish PE	Duplex system

	Reference	↑ mm	↔ mm	↔ mm	↔ mm	kg/m	⊞	Stock	Unit
	HDMP41.21.250.3S	41	21	2.50	3000	1.850	3	✓	m
	HDMP41.21.250.6S	41	21	2.50	6000	1.850	6	✓	m

MP41.41

Assembly profile

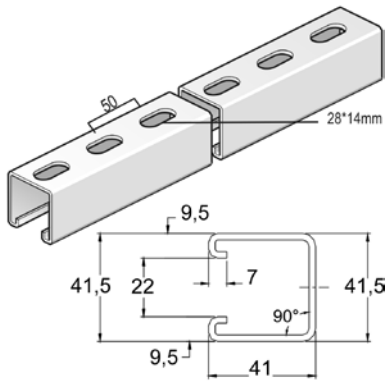

Profile opening	22 mm
Standard finish	Pre-galvanised
Optional finish PE	Coating

HD	Reference	↑ mm	↔ mm	↔ mm	↔ mm	kg/m	⊞	Stock	Unit
-	MP41.41.250.6S	41	41	2.50	6000	2.530	6	✓	m
-	MP41.41.250.3S	41	41	2.50	3000	2.530	3	✓	m

HDMP41.41

Assembly profile

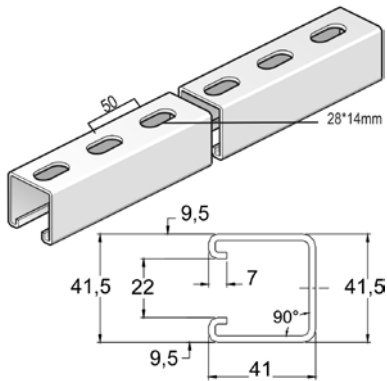

Profile opening	22 mm
Standard finish	Hot-dip galvanised
Optional finish PE	Duplex system

Reference	↑ mm	↔ mm	↔ mm	↔ mm	kg/m	⊞	Stock	Unit
HDMP41.41.250.3S	41	41	2.50	3000	2.700	3	✓	m
HDMP41.41.250.6S	41	41	2.50	6000	2.700	6	✓	m

MP41.41DG

Double assembly profile

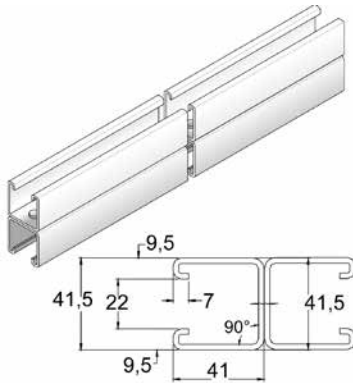

Profile opening	22 mm
Standard finish	Pre-galvanised
Optional finish PE	Coating

HD	Reference	↑ mm	↔ mm	↔ mm	↔ mm	kg/m	⊞	Stock	Unit
-	MP41.41.250.6DG	82	41	2.50	6000	5.330	6	✓	m

HDMP41.41DG

Double assembly profile

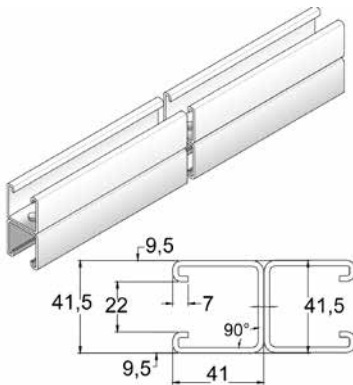

Profile opening	22 mm
Standard finish	Hot-dip galvanised
Optional finish PE	Duplex system

Reference	↑ mm	↔ mm	↔ mm	↔ mm	kg/m	⊞	Stock	Unit
HDMP41.41.250.6DG	82	41	2.50	6000	5.700	6	✓	m

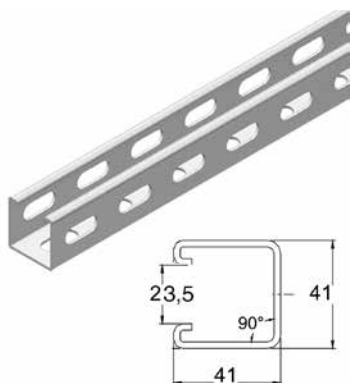
MP3.41.41**Assembly profile perforation on 3 sides**

Profile opening	23,5 mm
Standard finish	Pre-galvanised
Optional finish HD	Hot-dip galvanised

HD	Reference	↑ mm	↔ mm	↔ mm	↔ mm	kg/m	⊞	Stock	Unit
HD	MP3.41.41.200.3	41	41	2.00	3000	1.800	3	✓	m

SKPE**Adjustable head plate single**

Profile opening	23,5 mm
Standard finish	Pre-galvanised

HD	Reference	↑ mm	↔ mm	↔ mm	↔ mm	kg/piece	⊞	Stock	Unit
-	SKPE41	92	40		135	0.370	12	✓	piece

The technical information for this product can be found at the end of this chapter.
To order per full packaging.

SKPD**Adjustable head plate double**

Profile opening	23,5 mm
Standard finish	Pre-galvanised

HD	Reference	↑ mm	↔ mm	↔ mm	↔ mm	kg/piece	⊞	Stock	Unit
-	SKPD41	92	46		135	0.532	12	✓	piece

The technical information for this product can be found at the end of this chapter.
To order per full packaging.

VS41

Assembly accessory

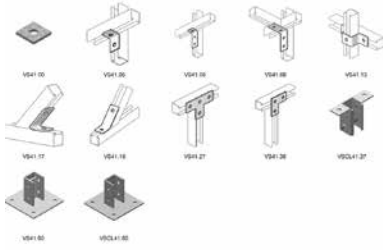

Standard finish

Electro zinc-plated

HD	Reference	↑ mm	↔ mm	↔ mm	↔ mm	kg/piece	⊞	Stock	Unit
-	VS41.00	-	40	6.00	-	0.065	24		piece
-	VS41.05	-	40	5.00	-	0.130	24	✓	piece
-	VS41.06	-	40	5.00	-	0.190	24		piece
-	VS41.08	-	40	5.00	-	0.260	24		piece
-	VS41.13	-	40	5.00	-	0.320	12		piece
-	VS41.17	-	40	5.00	-	0.240	12		piece
-	VS41.18	-	40	5.00	-	0.210	12		piece
-	VS41.27	-	40	5.00	-	0.290	12		piece
-	VS41.36	-	40	5.00	-	0.210	12		piece
-	VSCL41.37	-	-	-	-	0.800	6	✓	piece

The technical information for this product can be found at the end of this chapter.

To order per full packaging.

HDVS41 | 00-39

Assembly accessory



Standard finish

Hot-dip galvanised

Optional finish PE

Duplex system

Reference	↑ mm	↔ mm	↗ mm	↔ mm	kg/piece	📦	Stock	Unit
HDVS41.00	-	40	6.00	-	0.065	24	✓	piece
HDVS41.01	-	40	5.00	-	0.130	24	✓	piece
HDVS41.02	-	40	5.00	-	0.190	24	✓	piece
HDVS41.03	-	40	5.00	-	0.260	24	✓	piece
HDVS41.04	-	40	5.00	-	0.320	24	✓	piece
HDVS41.05	-	40	5.00	-	0.130	24	✓	piece
HDVS41.06	-	40	5.00	-	0.190	24	✓	piece
HDVS41.07	-	40	5.00	-	0.200	24	✓	piece
HDVS41.08	-	40	5.00	-	0.260	24	✓	piece
HDVS41.09	-	40	5.00	-	0.190	24	✓	piece
HDVS41.10	-	40	5.00	-	0.160	24	✓	piece
HDVS41.12	-	40	5.00	-	0.260	12	✓	piece
HDVS41.13	-	40	5.00	-	0.320	12	✓	piece
HDVS41.14	-	40	5.00	-	0.460	12	✓	piece
HDVS41.16	-	40	5.00	-	0.270	12	✓	piece
HDVS41.17	-	40	5.00	-	0.240	12	✓	piece
HDVS41.18	-	40	5.00	-	0.210	12	✓	piece
HDVS41.19	-	40	5.00	-	0.270	12	✓	piece
HDVS41.20	-	40	5.00	-	0.350	12	✓	piece
HDVS41.25	-	40	5.00	-	0.250	12	✓	piece
HDVS41.26	-	40	5.00	-	0.360	12	✓	piece
HDVS41.27	-	40	5.00	-	0.290	12	✓	piece
HDVS41.28	-	40	5.00	-	0.290	12	✓	piece
HDVS41.31	-	40	5.00	-	0.340	12	✓	piece
HDVS41.36	-	40	5.00	-	0.210	12	✓	piece
HDVS41.37	-	40	5.00	-	0.470	12	✓	piece
HDVSCL41.37	-			-	0.800	6	✓	piece
HDVS41.38	-	40	5.00	-	0.640	12	✓	piece
HDVS41.39	-	40	5.00	-	0.920	12	✓	piece

The technical information for this product can be found at the end of this chapter.

To order per full packaging.

HDVS41 | 41-62

Assembly accessory

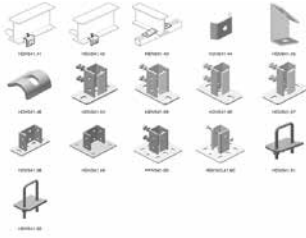

Standard finish	Hot-dip galvanised
Optional finish PE	Duplex system

Reference	↑ mm	↔ mm	↔ mm	↔ mm	kg/piece	⊠	Stock	Unit
HDVS41.41	-	40	5.00	-	0.370	12	✓	piece
HDVS41.42	-	40	5.00	-	0.330	12	✓	piece
HDVS41.43	-	40	8.00	-	0.200	12	✓	piece
HDVS41.44	-	40	5.00	-	0.145	48	✓	piece
HDVS41.45	-	40	3.00	-	0.100	12	✓	piece
HDVS41.46	-	40	6.00	-	0.135	12	✓	piece
HDVS41.54	-	40	5.00	-	1.100	6	✓	piece
HDVS41.55	-	40	5.00	-	1.100	6	✓	piece
HDVS41.56	-	40	5.00	-	0.800	6	✓	piece
HDVS41.57	-	40	5.00	-	0.800	6	✓	piece
HDVS41.58	-	40	5.00	-	1.400	6	✓	piece
HDVS41.59	-	40	5.00	-	1.554	6		piece
HDVS41.60	-	40	5.00	-	0.800	6		piece
HDVSCL41.60	-			-	0.800	6	✓	piece
HDVS41.61	-	40	5.00	-	0.363	6		piece
HDVS41.62	-	40	5.00	134	0.363	6		piece

The technical information for this product can be found at the end of this chapter.
To order per full packaging.

5

TIM

Threaded rod (DIN 975)



Standard finish	Electro zinc-plated
Optional finish HD	Hot-dip galvanised

Reference	Max. load (in daN)
TIM6	300
TIM8	550
TIM10	900
TIM12	1300

HD	Reference	↑ mm	↔ mm	↔ mm	↔ mm	kg/m	⊠	Stock	Unit
HD	TIM6	-		M6	2000	0.177	100	✓	m
HD	TIM8	-		M8	2000	0.319	50	✓	m
HD	TIM10	-		M10	2000	0.500	50	✓	m
HD	TIM12	-		M12	2000	0.725	40	✓	m

Fix with:									
HD	Reference	↑ mm	↔ mm	↔ mm	↔ mm	kg/m	⊠	Stock	Unit
HD	M8	-	-	M8	-	0.005	100	✓	piece
HD	M10	-	-	M10	-	0.010	100	✓	piece
HD	M12	-	-	M12	-	0.017	100	✓	piece
HD	RO8	-	-	M8	-	0.002	100	✓	piece
HD	RO10	-	-	M10	-	0.004	100	✓	piece
HD	RO12	-	-	M12	-	0.006	100	✓	piece

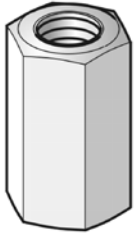
VM6334**Coupling nut (DIN 6334)**

Standard finish

Electro zinc-plated

HD	Reference	↑ mm	↔ mm	↔ mm	↔ mm	kg/piece	⊞	Stock	Unit
-	VM6	18		M6	-	0.009	50	✓	piece
-	VM8	24		M8	-	0.021	50	✓	piece
-	VM10	30		M10	-	0.042	50	✓	piece
-	VM12	36		M12	-	0.059	50	✓	piece

To order per full packaging.

GM

Sliding nut for supporting profile

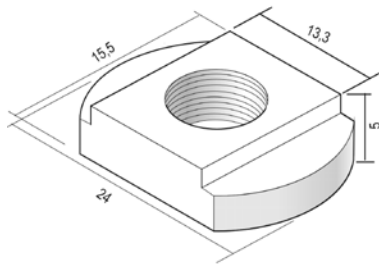

Standard finish

Electro zinc-plated

Optional finish HD

Hot-dip galvanised

HD	Reference	↑ mm	↔ mm	⊘ mm	↔ mm	kg/piece	📦	Stock	Unit
HD	GM6	-		M6	-	0.010	50	✓	piece
HD	GM8	-		M8	-	0.010	50	✓	piece

To order per full packaging.
Fits in the rung of the cable ladders KL, HDKS and KLL(I).

GM41

Sliding nut for supporting profile

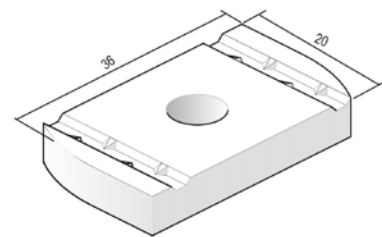

For stepless fixing of the brackets on the ceiling profiles.

Standard finish

Electro zinc-plated

Optional finish HD

Hot-dip galvanised

HD	Reference	↑ mm	↔ mm	⊘ mm	↔ mm	kg/piece	📦	Stock	Unit
HD	GM41M6	-		M6	-	0.026	50	✓	piece
HD	GM41M8	-		M8	-	0.030	50	✓	piece
HD	GM41M10	-		M10	-	0.040	50	✓	piece
HD	GM41M12	-		M12	-	0.040	50	✓	piece

To order per full packaging.
Used with the profiles (HD)MP41.21 and (HD)MP41.41.
Fits in the rung of the cable ladders KLM, KLW, KLZ.

GMV41

Sliding nut spring supporting profile



Standard finish

Electro zinc-plated

HD	Reference	↑ mm	↔ mm	⊘ mm	↔ mm	kg/piece	📦	Stock	Unit
-	GMV41M6	-		M6	-	0.030	50	✓	piece
-	GMV41M8	-		M8	-	0.030	50	✓	piece
-	GMV41M10	-		M10	-	0.040	50	✓	piece
-	GMV41M12	-		M12	-	0.040	50	✓	piece

To order per full packaging.

B

Bolt (DIN 933)

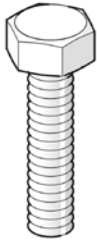

Standard finish

Electro zinc-plated

Optional finish HD

Hot-dip galvanised

HD	Reference	↑ mm	↔ mm	⊘ mm	↔ mm	kg/piece	📦	Stock	Unit
HD B6.20		-		M6	20	0.006	100	✓	piece
HD B6.30		-		M6	30	0.008	100	✓	piece
HD B8.20		-		M8	20	0.012	100	✓	piece
HD B8.30		-		M8	30	0.016	100	✓	piece
HD B8.40		-		M8	40	0.019	100	✓	piece
HD B8.50		-		M8	50	0.022	100	✓	piece
HD B8.70		-		M8	70	0.028	100	✓	piece
HD B10.20		-		M10	20	0.021	100	✓	piece
HD B10.30		-		M10	30	0.027	100	✓	piece
HD B10.40		-		M10	40	0.033	100	✓	piece
HD B10.80		-		M10	80	0.053	100	✓	piece
HD B12.20		-		M12	20	0.034	100	✓	piece
HD B12.30		-		M12	30	0.040	100	✓	piece
HD B12.40		-		M12	40	0.047	100	✓	piece
HD B12.50		-		M12	50	0.058	100	✓	piece

To order per full packaging.

RBK

Round head square neck bolt (DIN 603)



Standard finish

Electro zinc-plated

Optional finish HD

Hot-dip galvanised

HD	Reference	↑ mm	↔ mm	⊘ mm	↔ mm	kg/piece	📦	Stock	Unit
HD RBK6.10		-		M6	10	0.006	100		piece
HD RBK6.20		-		M6	20	0.010	100		piece
HD RBK12.20		-		M12	20	0.052	100	✓	piece

To order per full packaging.

M

Nut (DIN 934)

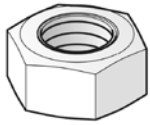

Standard finish

Electro zinc-plated

Optional finish HD

Hot-dip galvanised

HD	Reference	↑ mm	↔ mm	⊘ mm	↔ mm	kg/piece	📦	Stock	Unit
HD	M6	-		M6	-	0.003	100	✓	piece
HD	M8	-		M8	-	0.005	100	✓	piece
HD	M10	-		M10	-	0.010	100	✓	piece
HD	M12	-		M12	-	0.017	100	✓	piece

To order per full packaging.
According to EN 024-034.

VM

Toothed round head bolt / flange nut



Standard finish

Electro zinc-plated

HD	Reference	↑ mm	↔ mm	⊘ mm	↔ mm	kg/piece	📦	Stock	Unit
-	VM4.40	-		M4	40	0.005	100	✓	piece
HD	VM6.10	-		M6	10	0.008	100	✓	piece
HD	VM6.20	-		M6	20	0.009	100	✓	piece
-	VM6.50	-		M6	50	0.015	100	✓	piece
-	VM8.16	-		M8	16	0.021	100	✓	piece
-	VM10.50	-		M10	50	0.041	100	✓	piece

To order per full packaging.
According to DIN 50 961.

VMK

Round head square neck bolt / flange nut

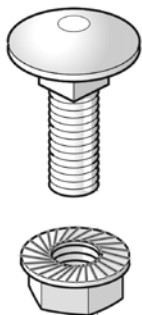

Standard finish

Electro zinc-plated

Optional finish HD

Hot-dip galvanised

HD	Reference	↑ mm	↔ mm	⊘ mm	↔ mm	kg/piece	📦	Stock	Unit
HD	VMK6.10	-		M6	-	0.009	100	✓	piece
-	VMK8.15	-		M8	-	0.021	100	✓	piece
HD	VMK12.20	-		M12	-	0.073	100	✓	piece

To order per full packaging.

RB**Toothed round head bolt**

Standard finish

Electro zinc-plated

Optional finish HD

Hot-dip galvanised

HD	Reference	↑ mm	↔ mm	↔ mm	↔ mm	kg/piece	📦	Stock	Unit
HD	RB6.10	-		M6	10	0.004	100		piece
HD	RB6.20	-		M6	20	0.006	100		piece

To order per full packaging.

RM**Flange nut (DIN 6923)**

Standard finish

Electro zinc-plated

Optional finish HD

Hot-dip galvanised

HD	Reference	↑ mm	↔ mm	↔ mm	↔ mm	kg/piece	📦	Stock	Unit
HD	RM6	-		M6	-	0.003	100		piece
HD	RM8	-		M8	-	0.007	100		piece
HD	RM10	-		M10	-	0.006	100		piece
HD	RM12	-		M12	-	0.021	100		piece

To order per full packaging.

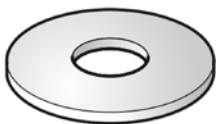
CRO**Flat giant washer (DIN 9021)**

Standard finish

Electro zinc-plated

Optional finish HD

Hot-dip galvanised

HD	Reference	↑ mm	↔ mm	↔ mm	↔ mm	kg/piece	📦	Stock	Unit
HD	CRO6	-		M6	-	0.003	100	✓	piece
HD	CRO8	-		M8	-	0.006	100	✓	piece
HD	CRO10	-		M10	-	0.012	100	✓	piece
HD	CRO12	-		M12	-	0.027	100	✓	piece

To order per full packaging.

RO

Giant washer (DIN 125-1 A)

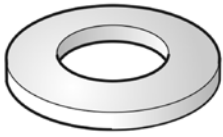

Standard finish

Electro zinc-plated

HD	Reference	↑ mm	↔ mm	⊘ mm	⇄ mm	kg/piece	📦	Stock	Unit
-	RO4	-		M4	-	0.001	100	✓	piece
-	RO6	-		M6	-	0.001	100	✓	piece
HD	RO8	-		M8	-	0.002	100	✓	piece
HD	RO10	-		M10	-	0.004	100	✓	piece
HD	RO12	-		M12	-	0.006	100	✓	piece

To order per full packaging.

ROTD

Vibration damping washer



HD	Reference	↑ mm	↔ mm	⊘ mm	⇄ mm	kg/piece	📦	Stock	Unit
-	ROTD8	9	32	12.00	-	0.012	100	✓	piece

To order per full packaging.

VSZ

Galvaspray 400 ml



HD	Reference	↑ mm	↔ mm	⊘ mm	⇄ mm	kg/piece	📦	Stock	Unit
-	VSSPRAY	-			-	0.450	12	✓	piece

To order per full packaging.

RBS

Edge protection



HD	Reference	↕ mm	↔ mm	↔ mm	↔ mm	kg/m	📦	Stock	Unit
-	RBS075.250	-				0.035	100	✓	m

To order per 10 m.

CSL

Technical information

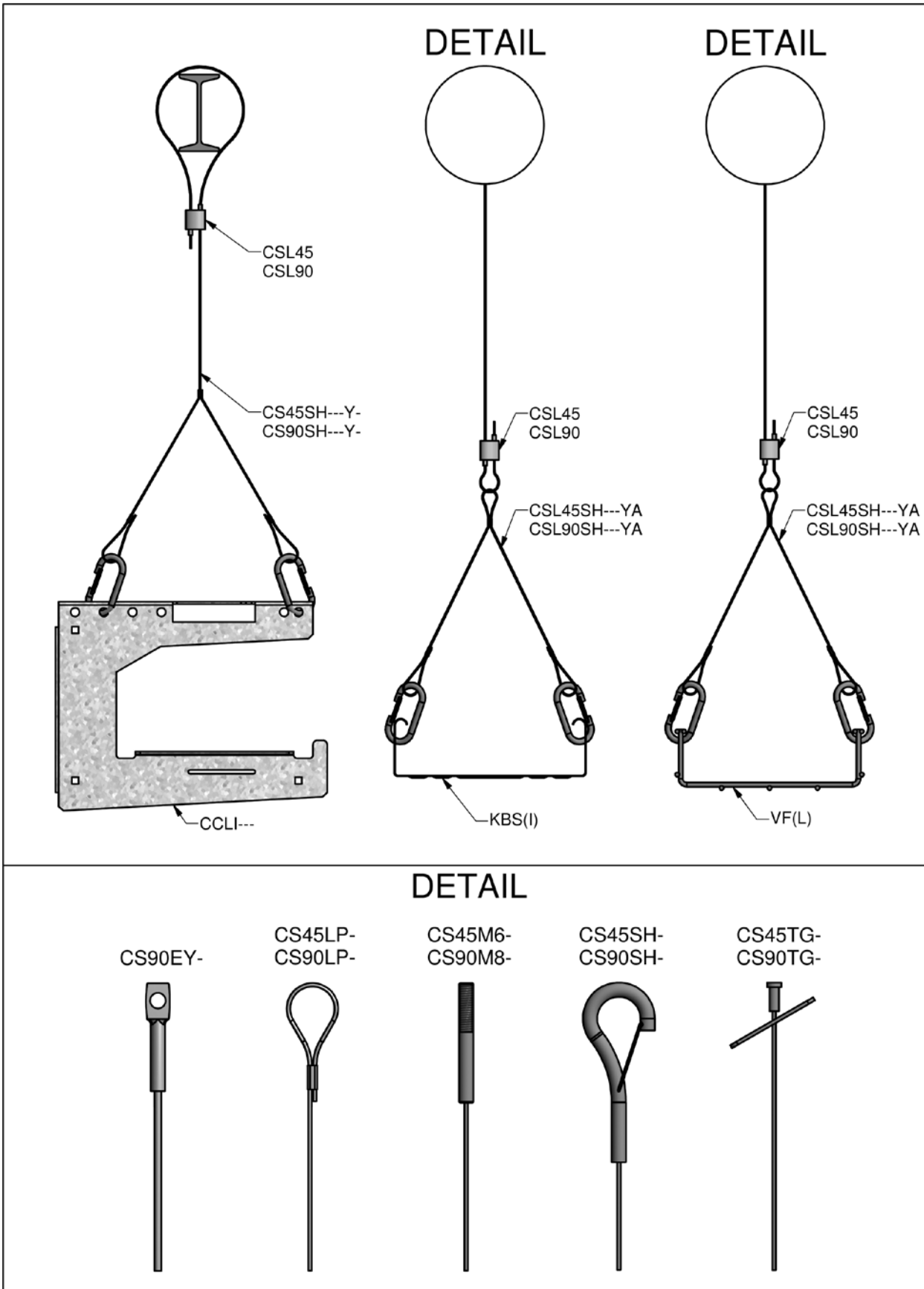

CCLI

Technical information

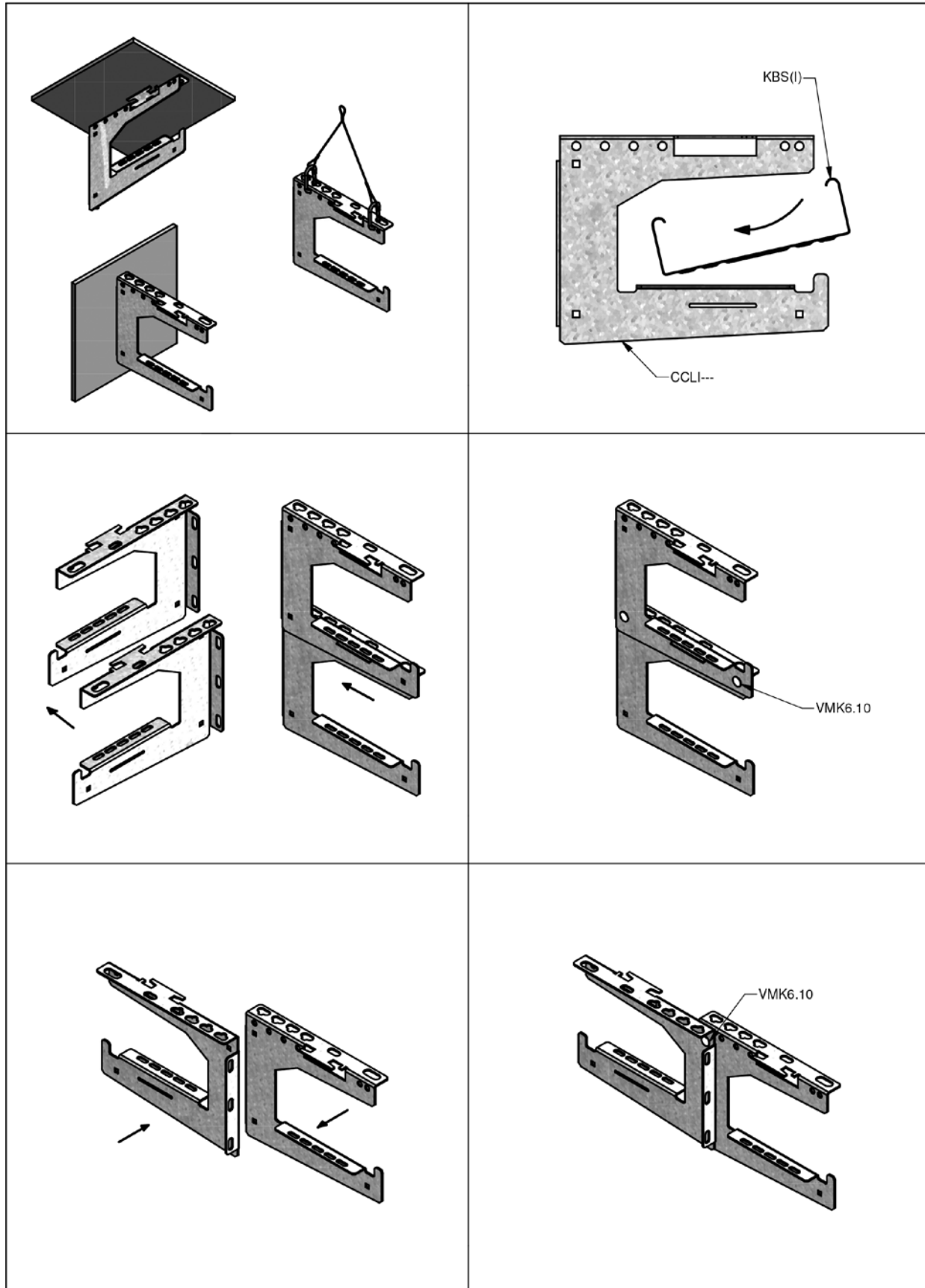

5

WSUN

Technical information

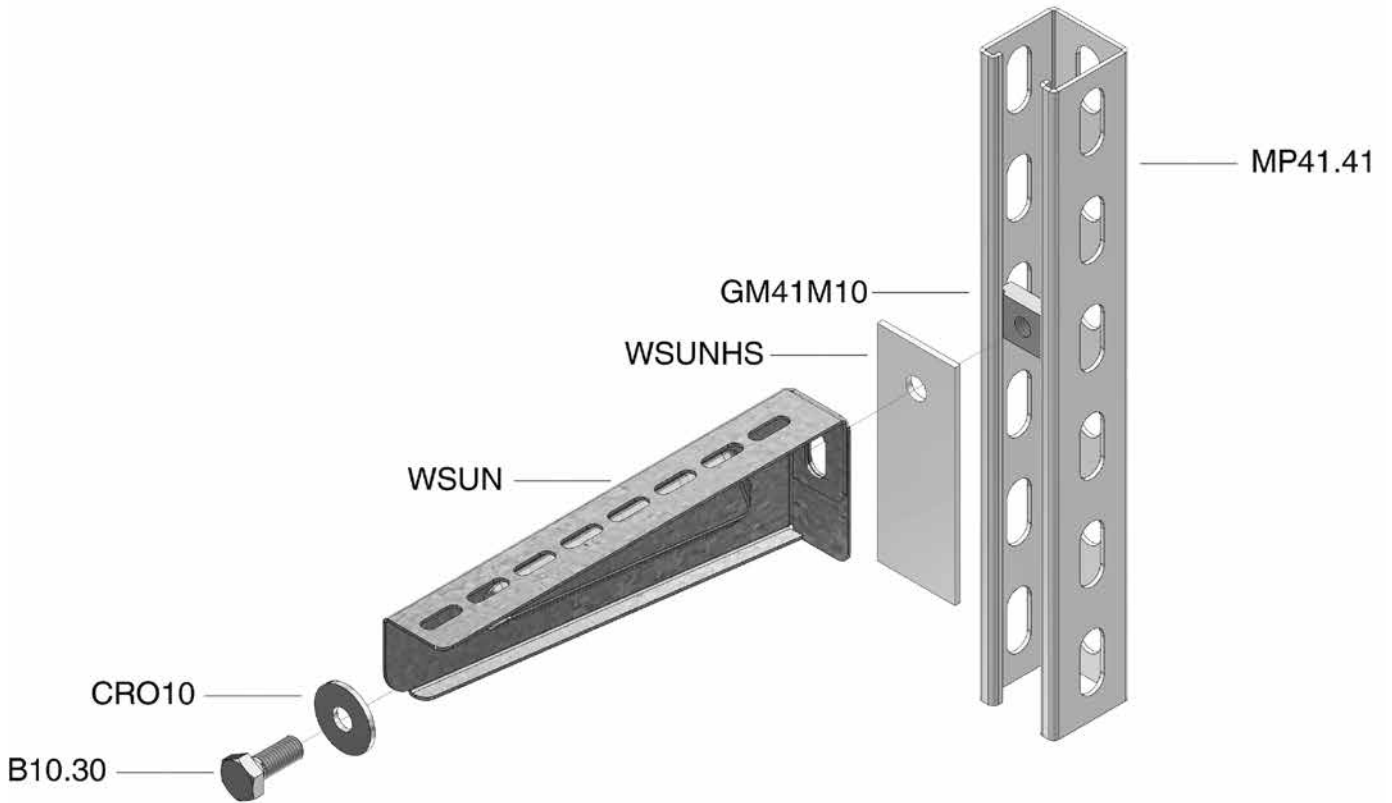

WKCL

Technical information

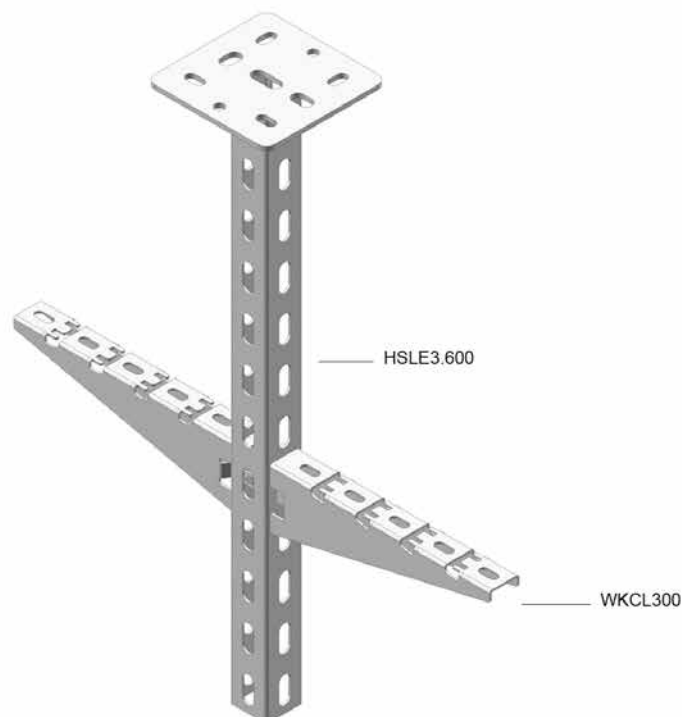

WKMPCL41.41**Technical information**

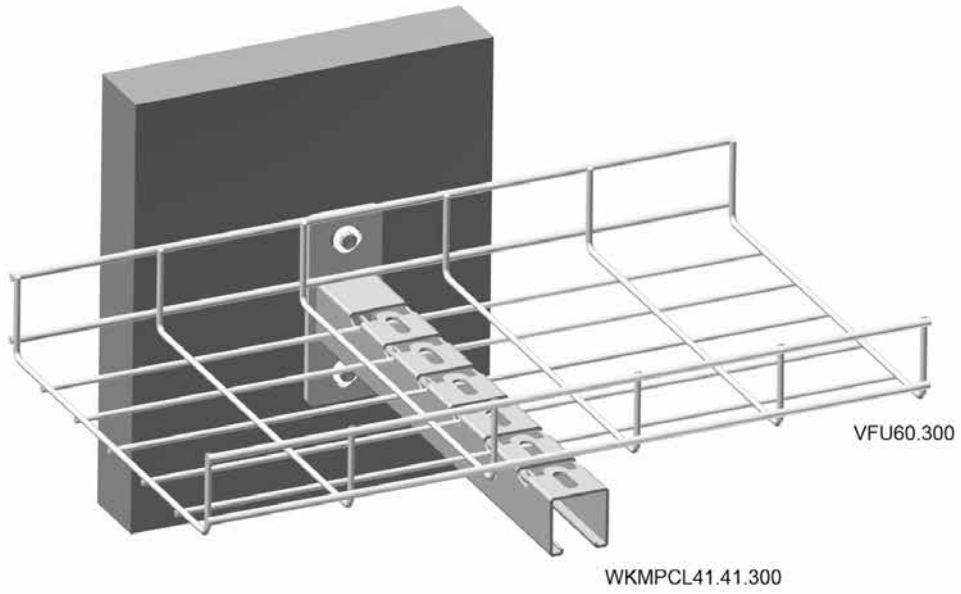

WKUMPCL41.41

Technical information

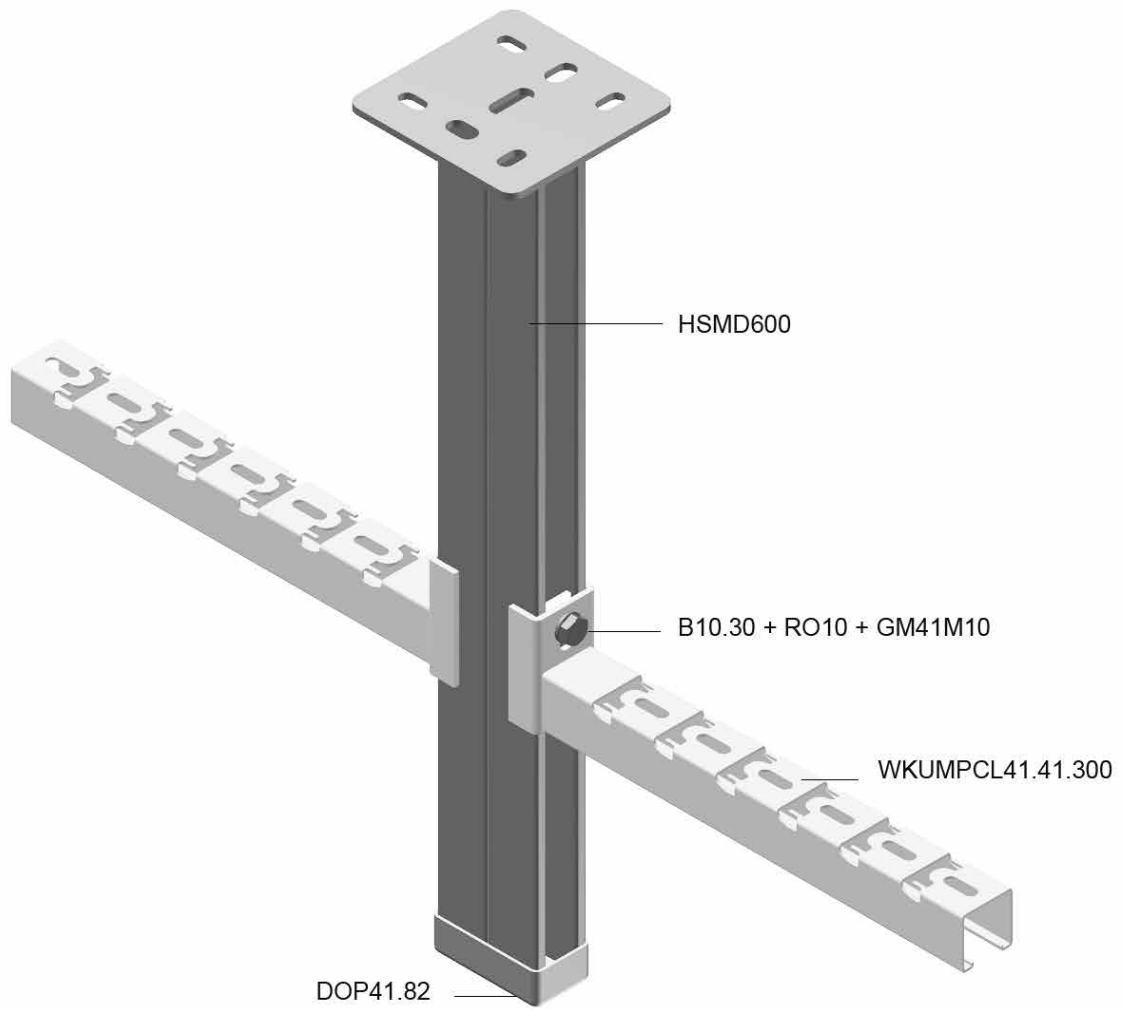

HDWKM

Technical information

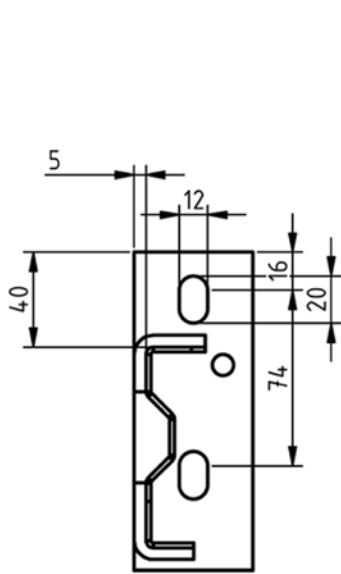

100-150

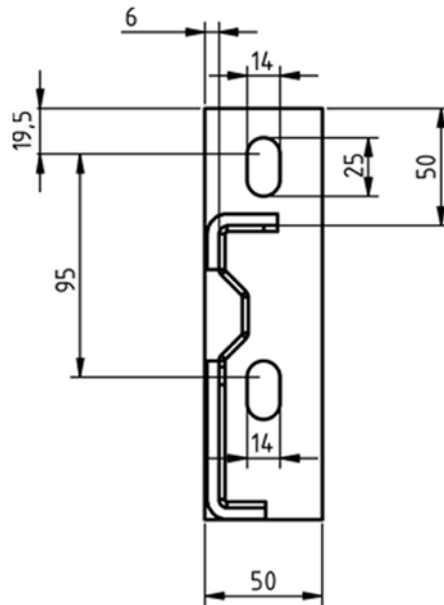

300-1000

HDWKMD

Technical information

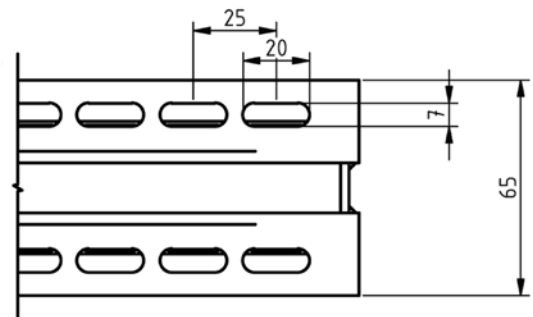
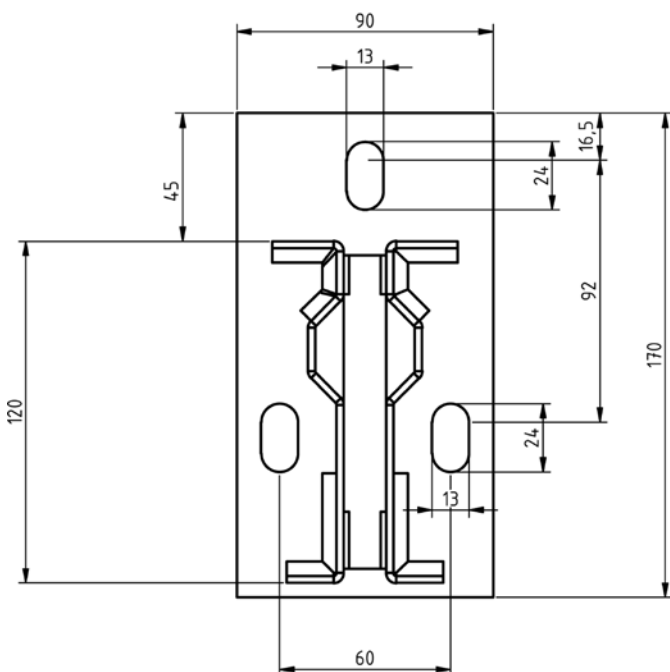

HDUKPIZ

Technical information

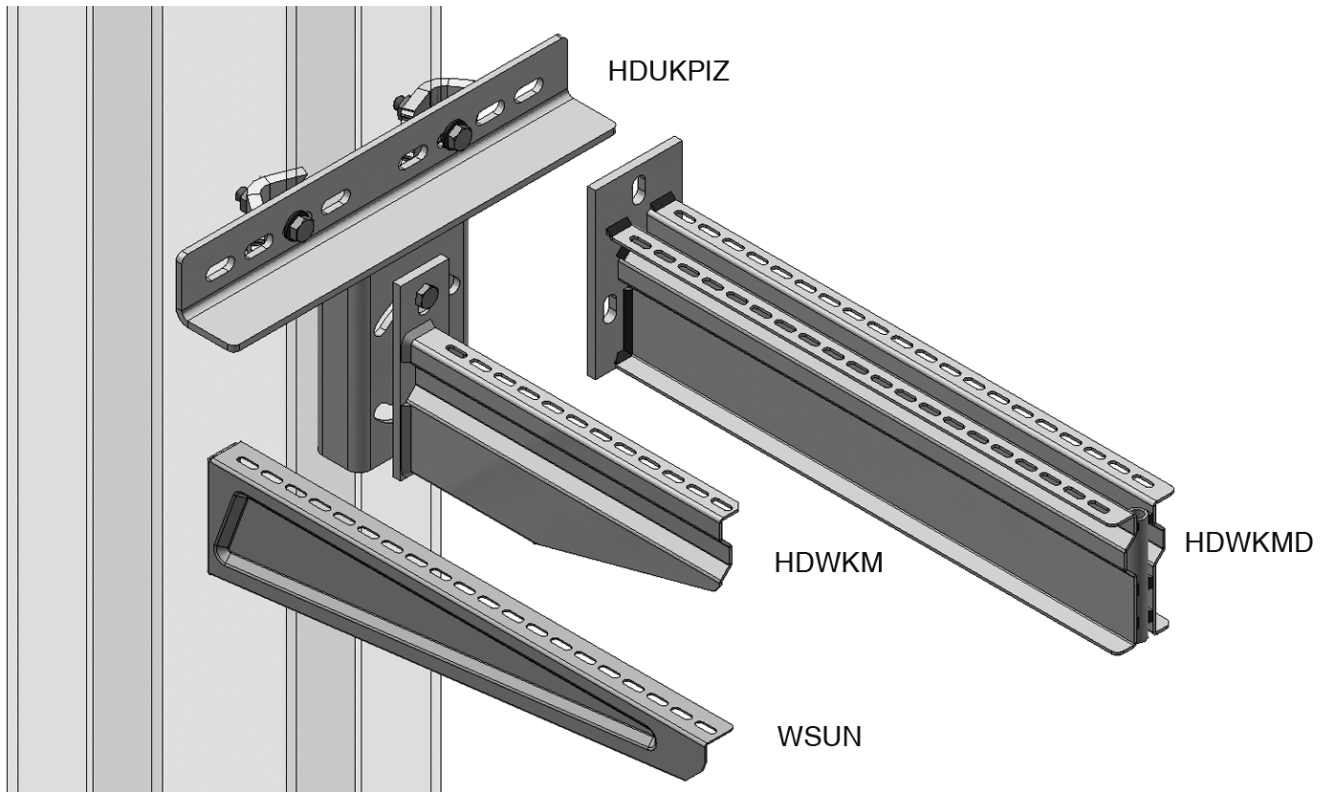

HDHSLECL

Technical information

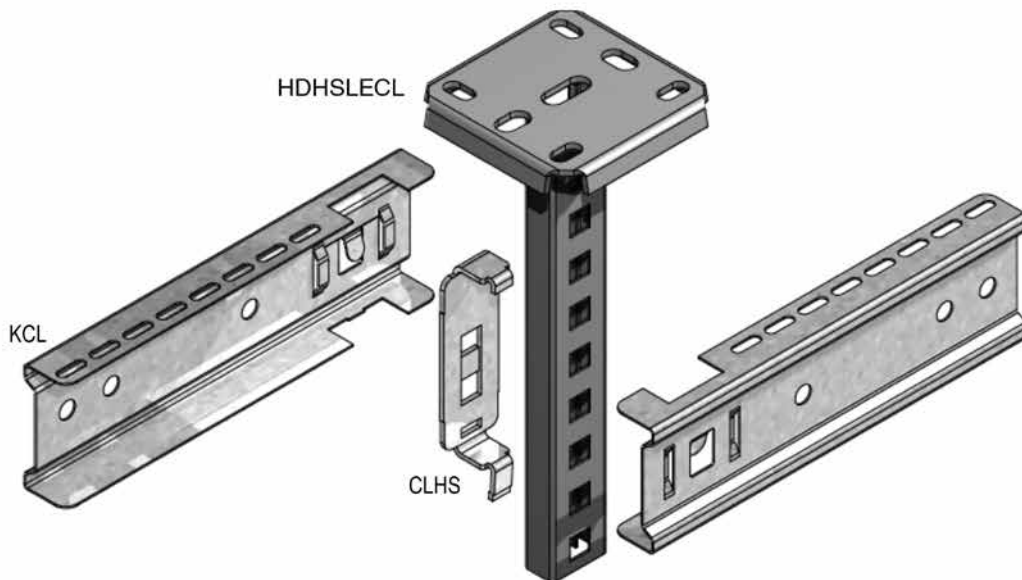

HDHSLDCL

Technical information

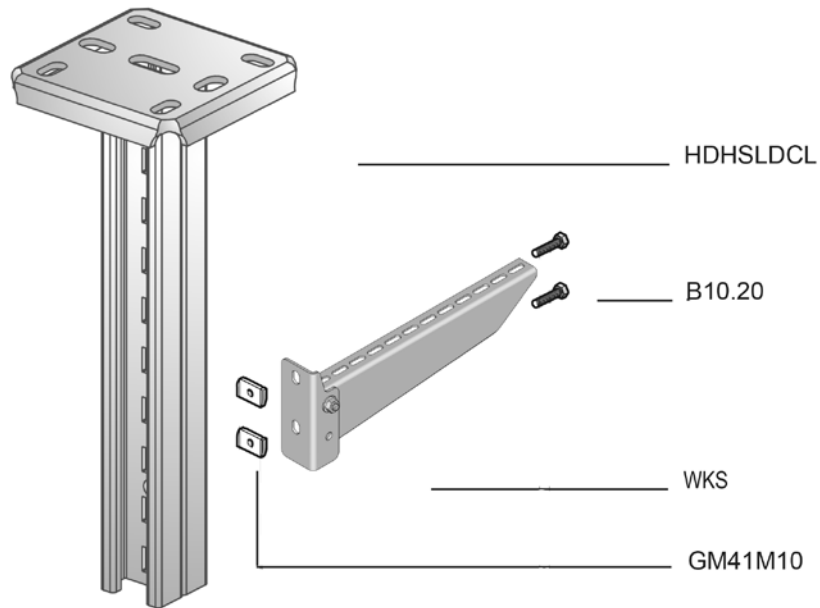

HSLE3

Technical information

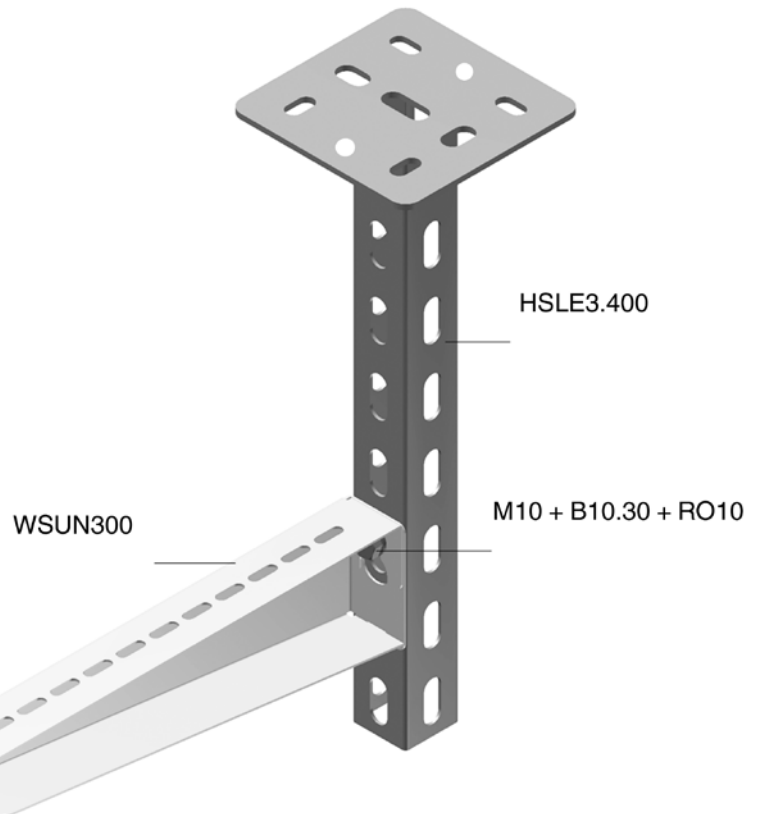
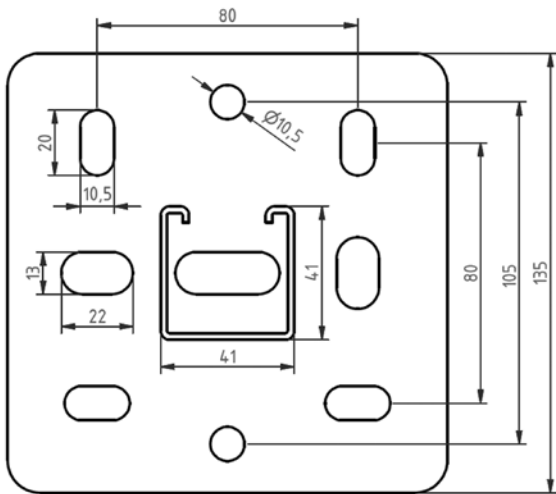

HSMD

Technical information

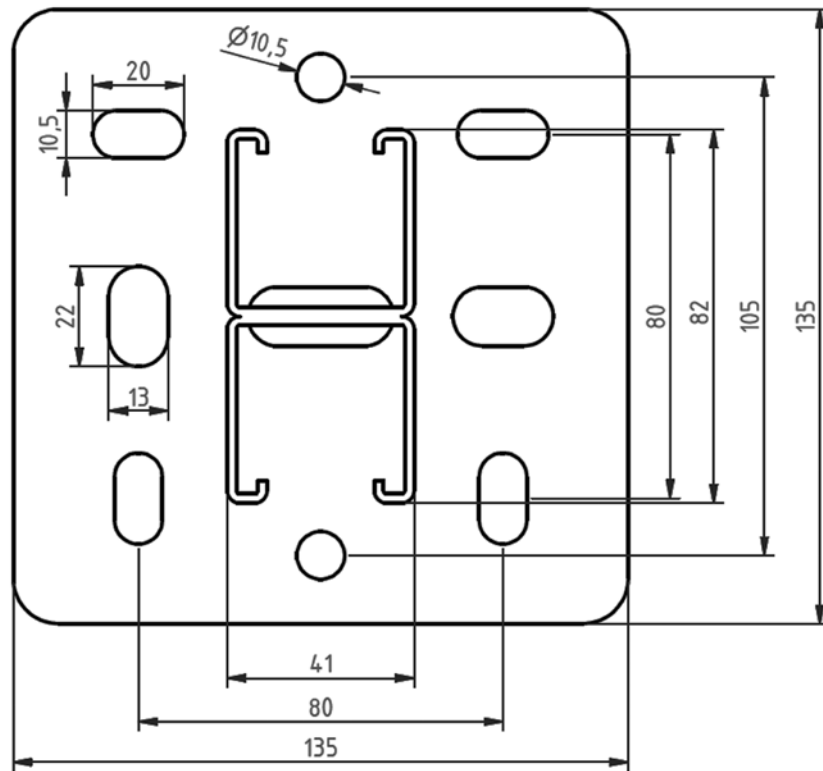

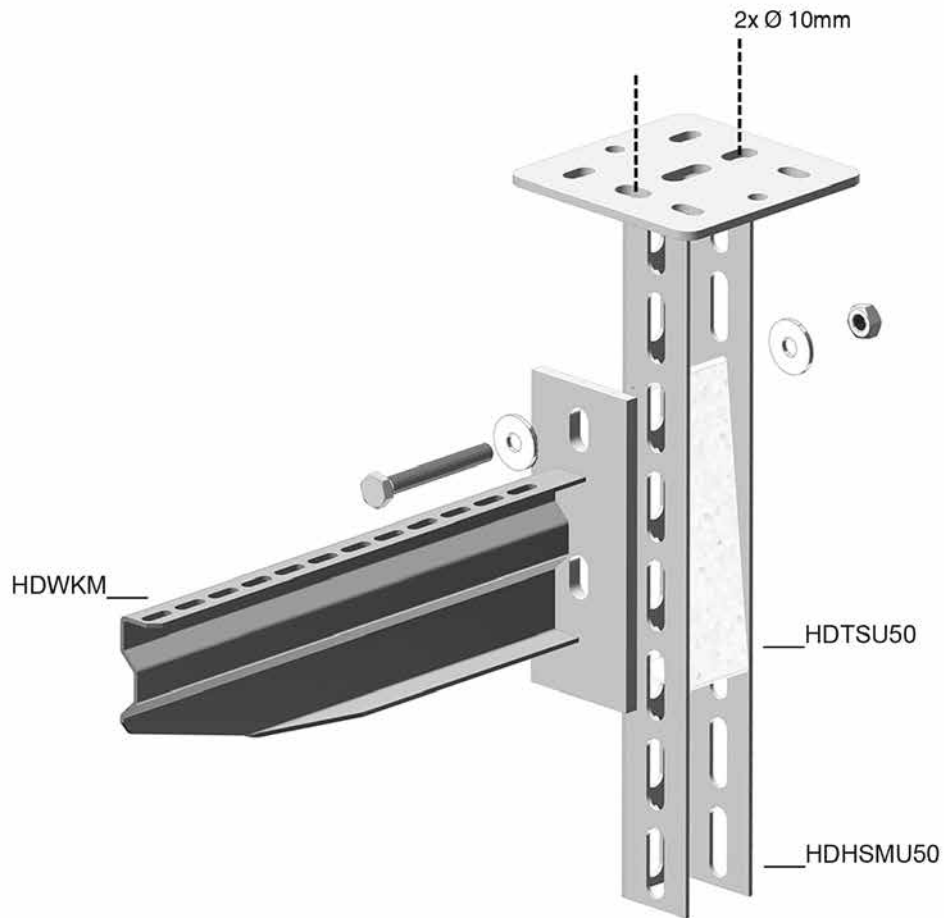
HDHSMU50**Technical information**

HDTSU

Technical information

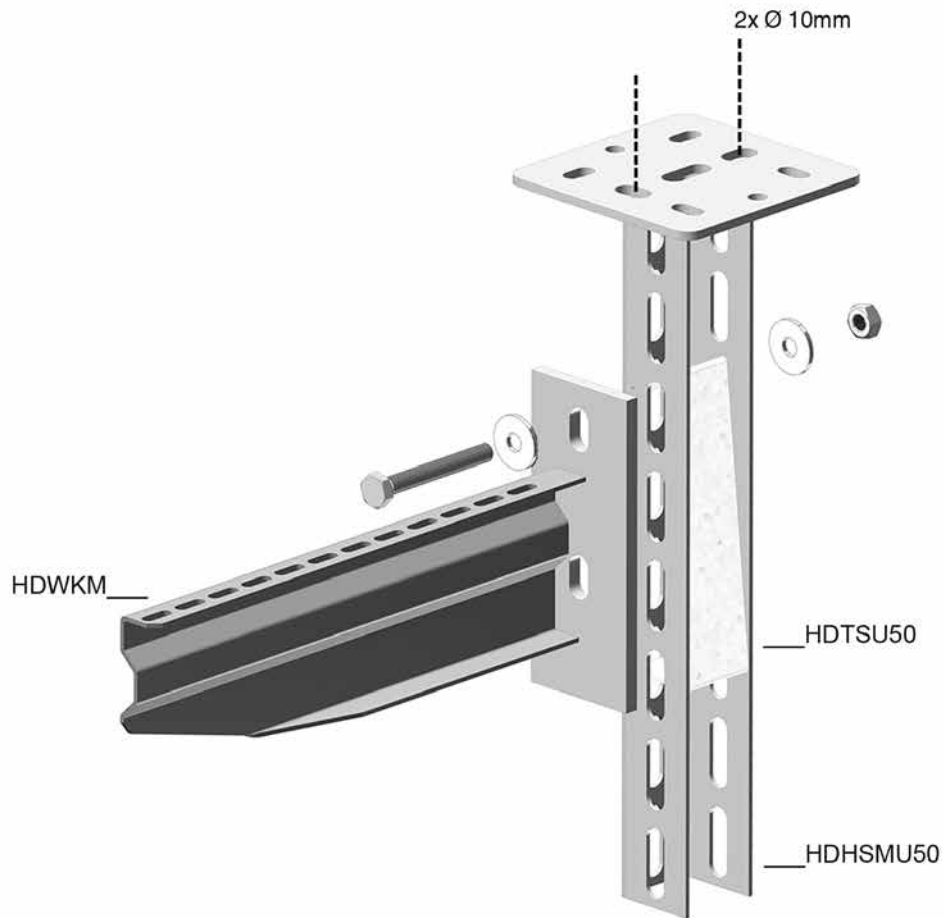

HDHSIZ

Technical information

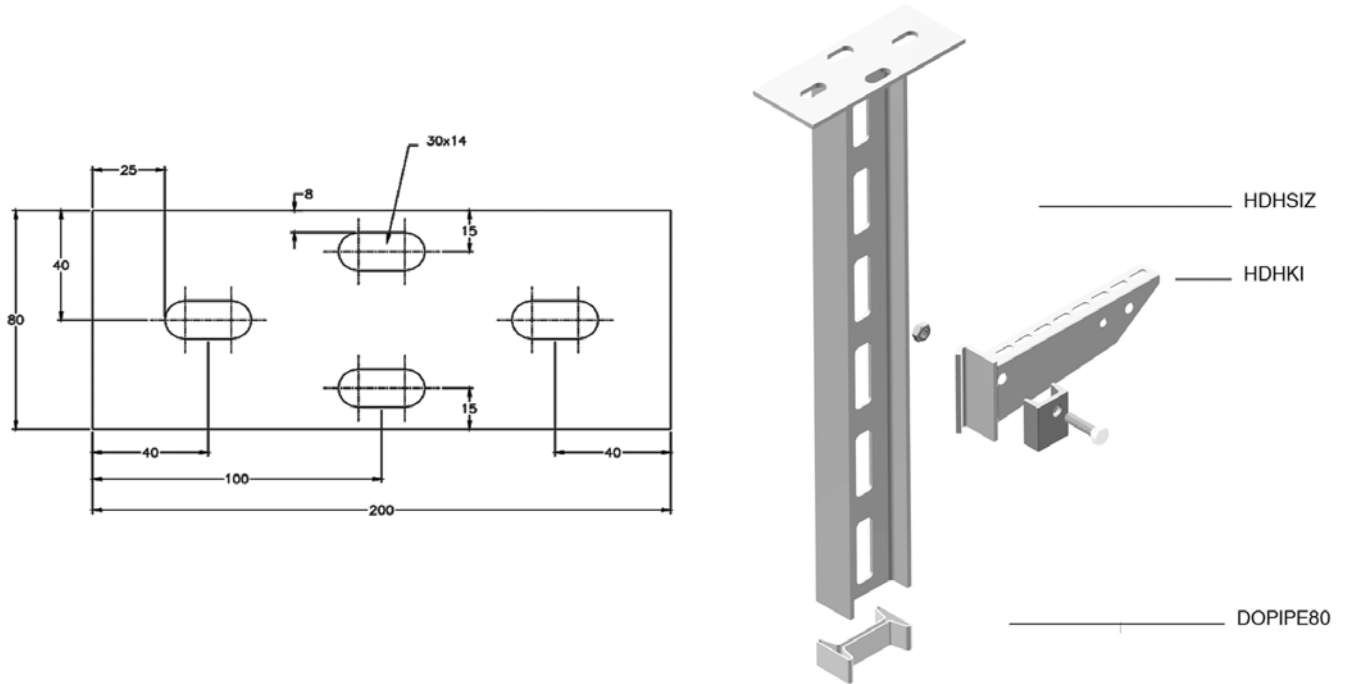

5

HDSKP

Technical information

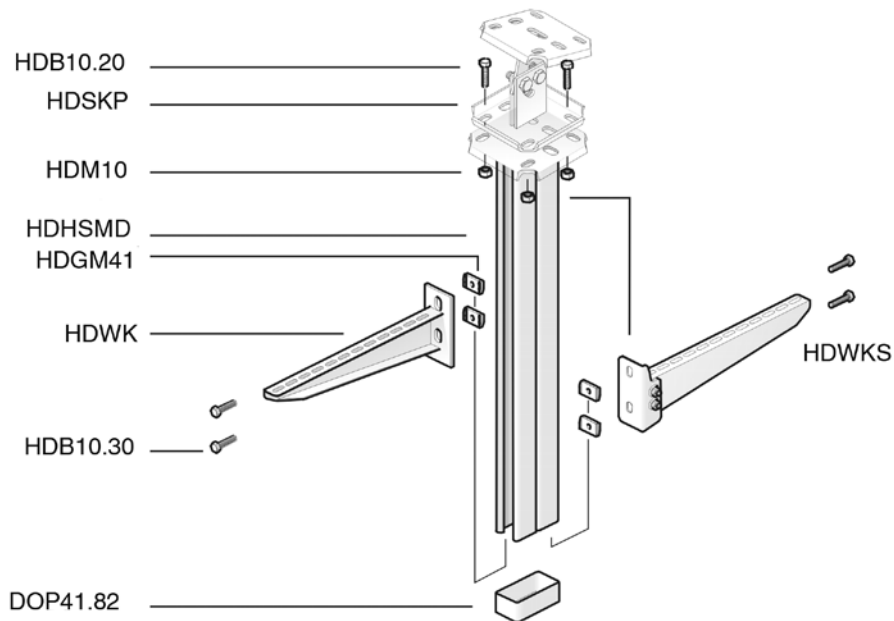

HDIPL06

Technical information

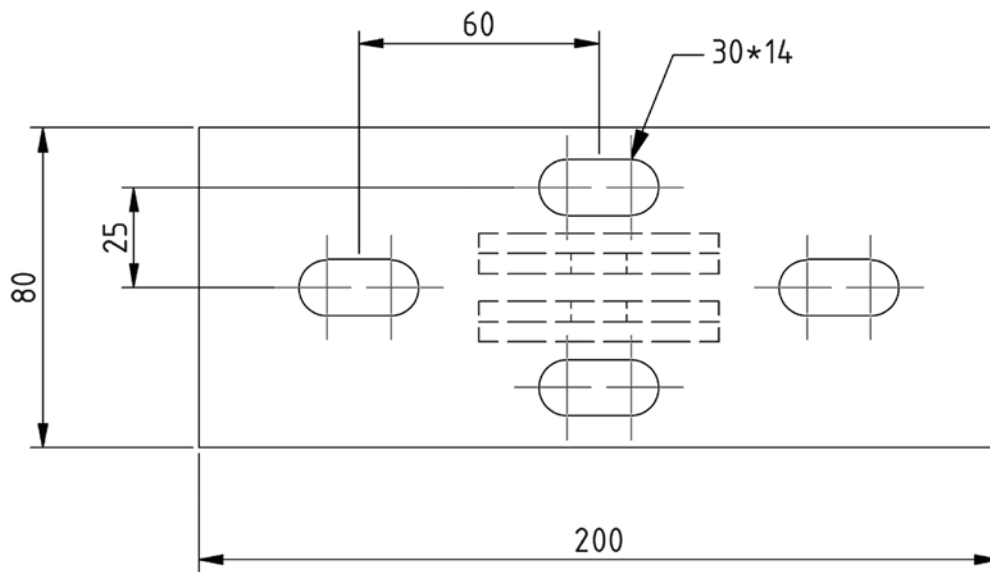

HDIPL10

Technical information

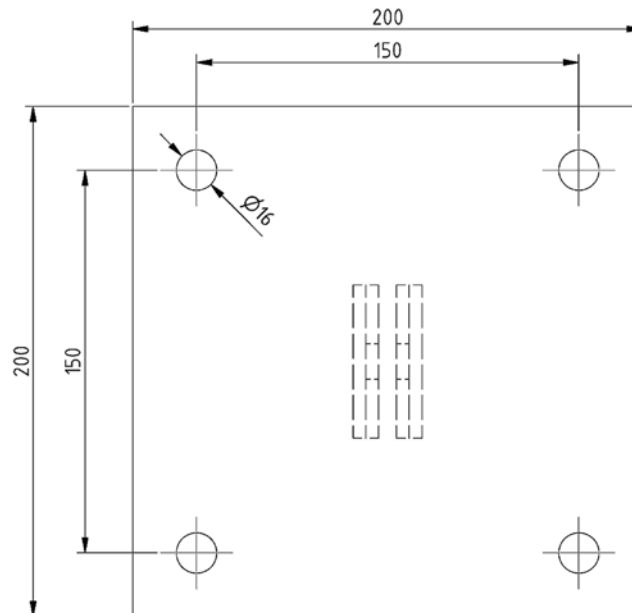

HDSKIPE

Technical information

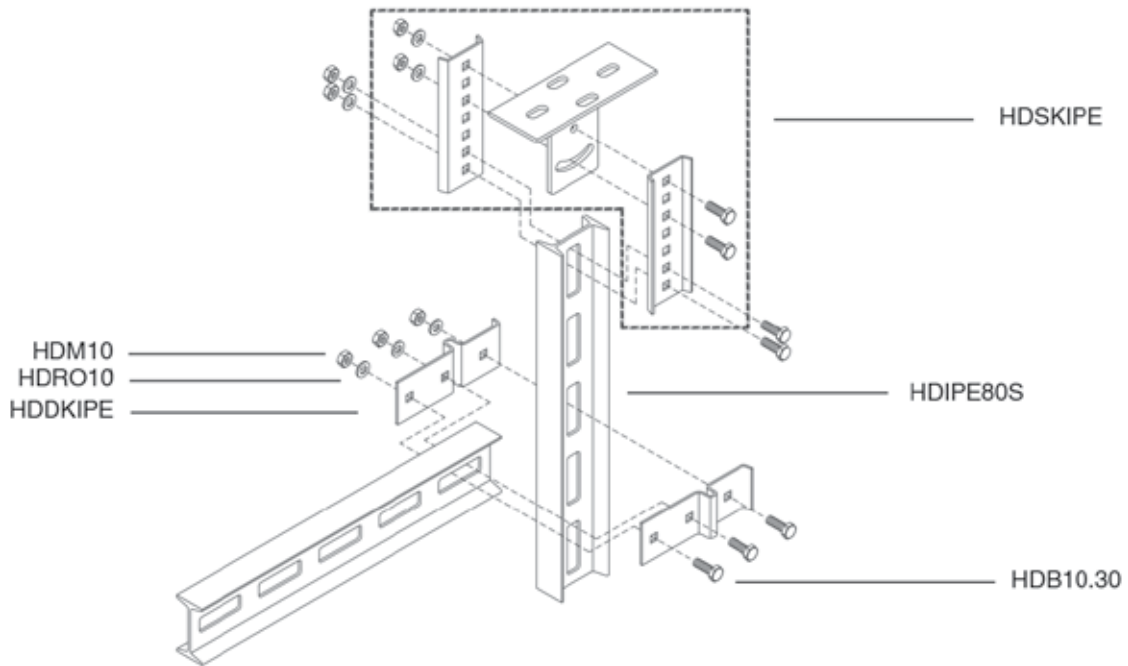

5

Z25

Technical information

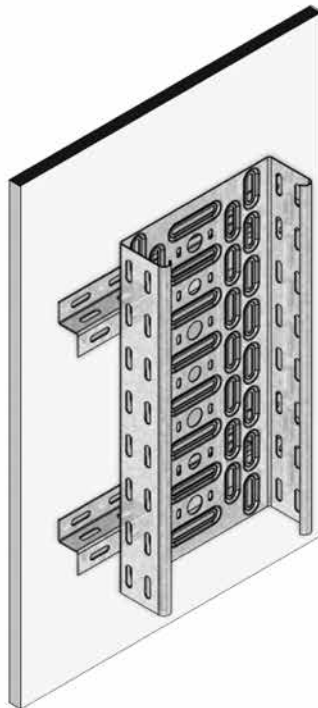

SKPE

Technical information

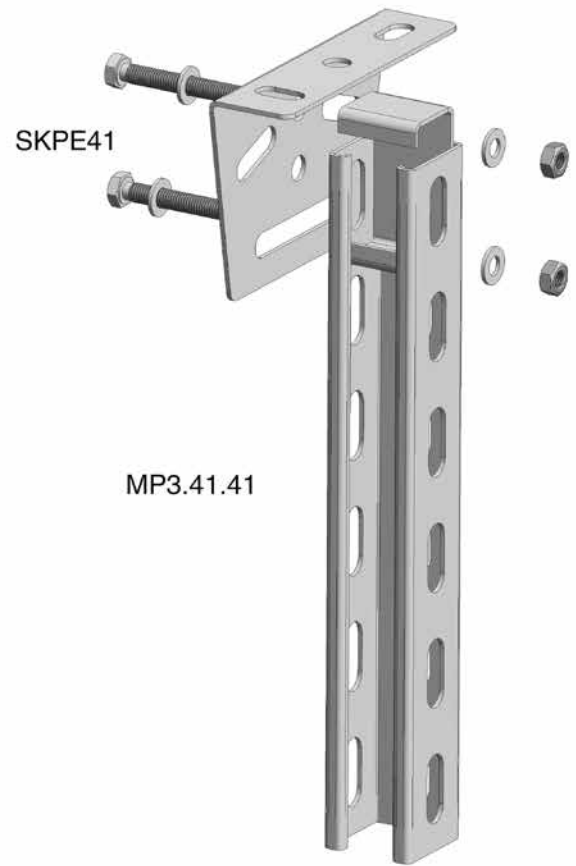
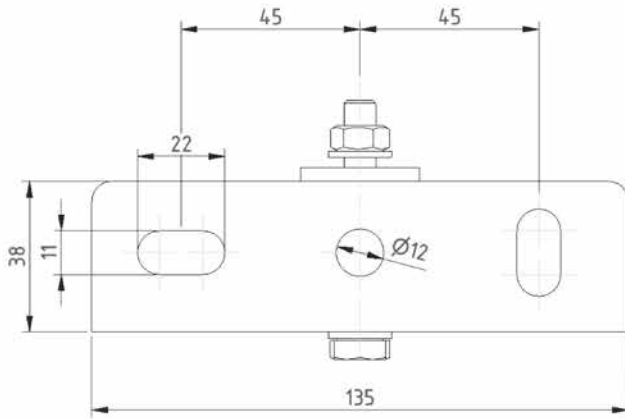

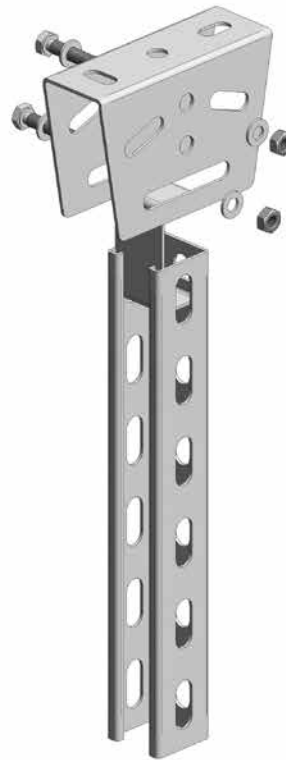
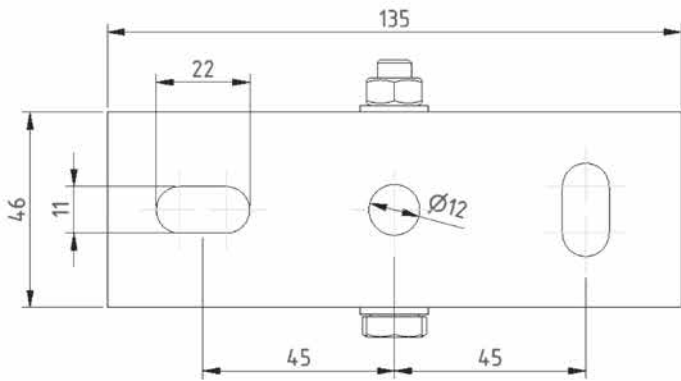
SKPD**Technical information**

SKPD41

MP3.41.41

VS41

Technical information

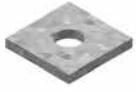

VS41.00

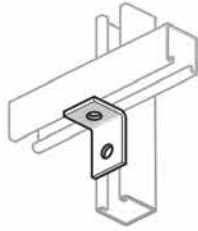

VS41.05



VS41.06

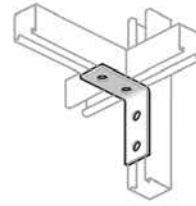

VS41.08

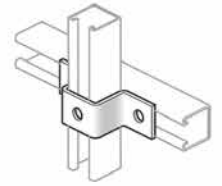

VS41.13



VS41.17

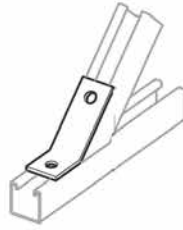

VS41.18

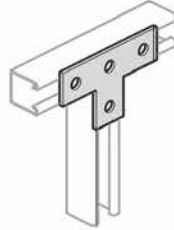

VS41.27

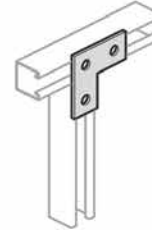

VS41.36



VSCL41.37

HDVS41 | 00-39

Technical information

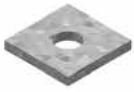

HDVS41.00

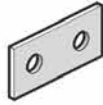

HDVS41.01

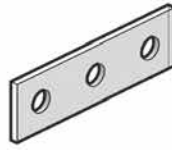

HDVS41.02

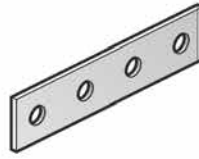

HDVS41.03

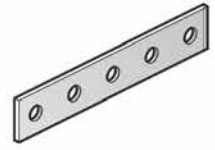

HDVS41.04

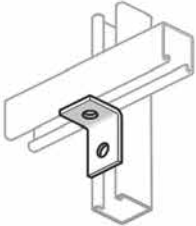

HDVS41.05



HDVS41.06

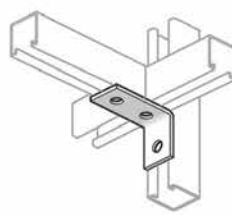

HDVS41.07

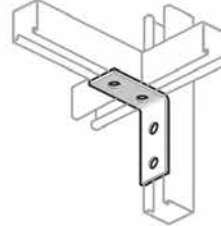

HDVS41.08

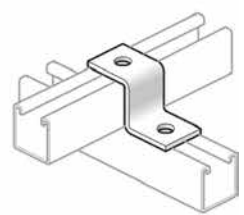

HDVS41.09

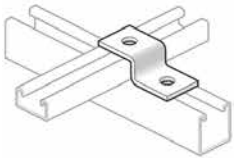

HDVS41.10

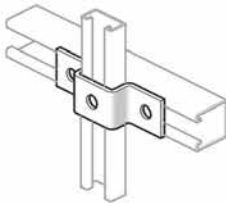

HDVS41.12

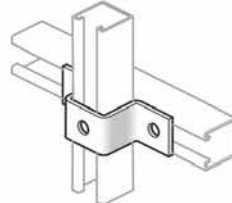

HDVS41.13

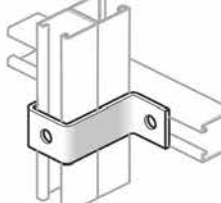

HDVS41.14

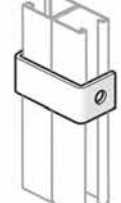

HDVS41.16



HDVS41.17



HDVS41.18



HDVS41.19



HDVS41.20

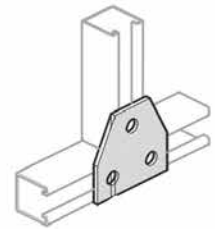

HDVS41.25

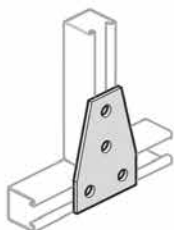

HDVS41.26

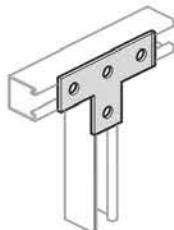

HDVS41.27

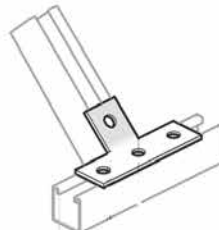

HDVS41.28

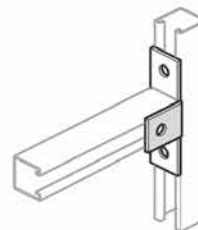

HDVS41.31

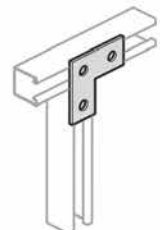

HDVS41.36

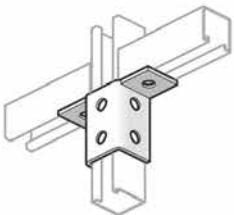

HDVS41.37



HDVSCL41.37



HDVS41.38

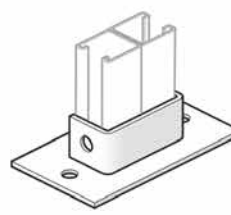

HDVS41.39

5

HDVS41 | 41-62

Technical information

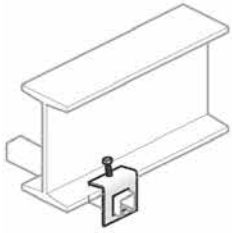

HDVS41.41

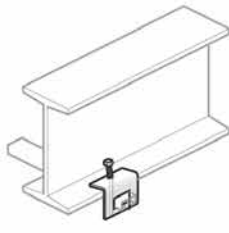

HDVS41.42

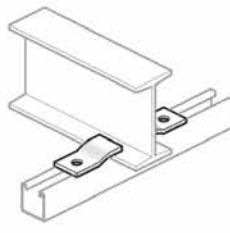

HDVS41.43



HDVS41.44



HDVS41.45



HDVS41.46



HDVS41.54



HDVS41.55



HDVS41.56



HDVS41.57



HDVS41.58



HDVS41.59



HDVS41.60



HDVSCL41.60



HDVS41.61



HDVS41.62